

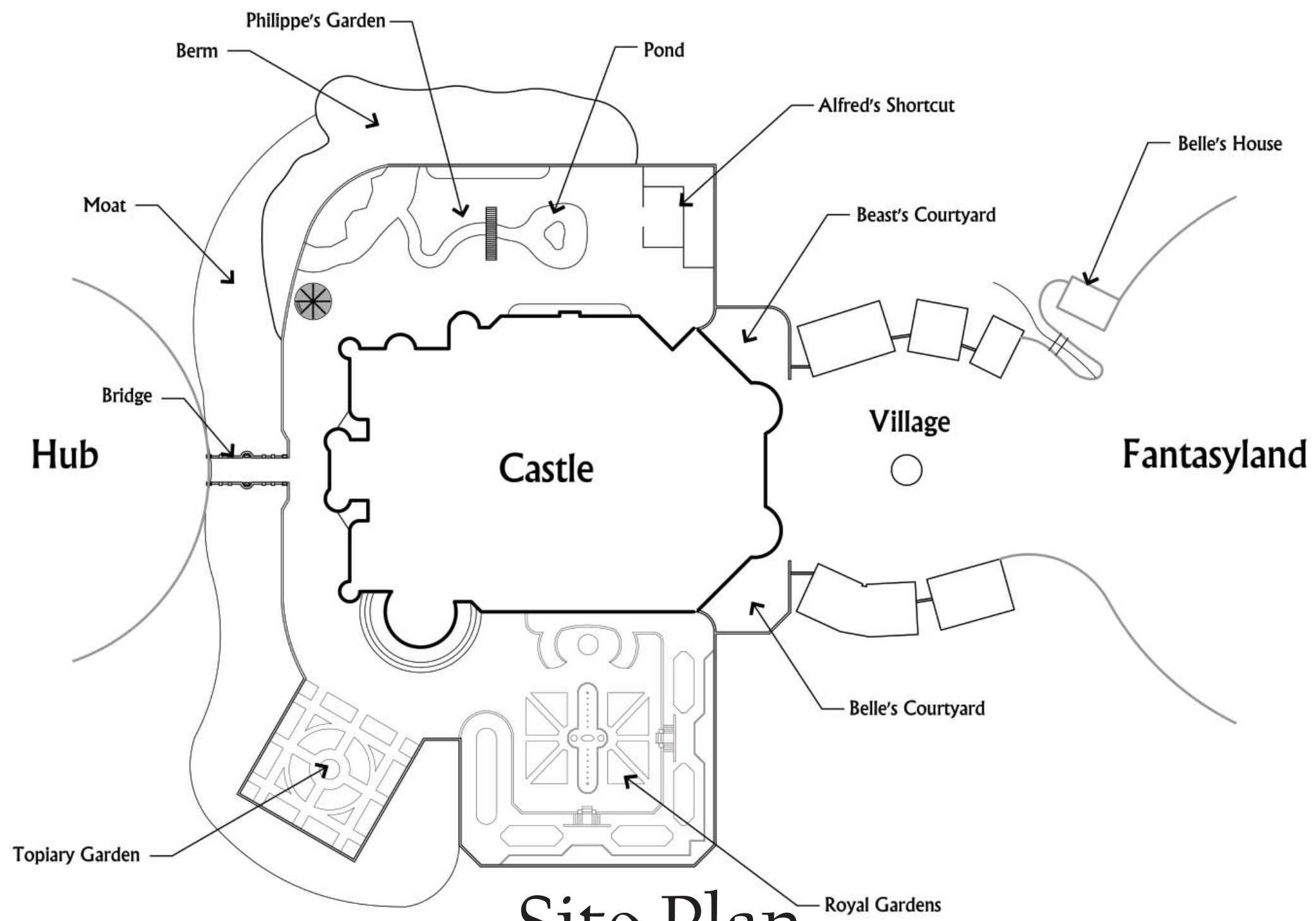

Le Château de la Belle et la Bête

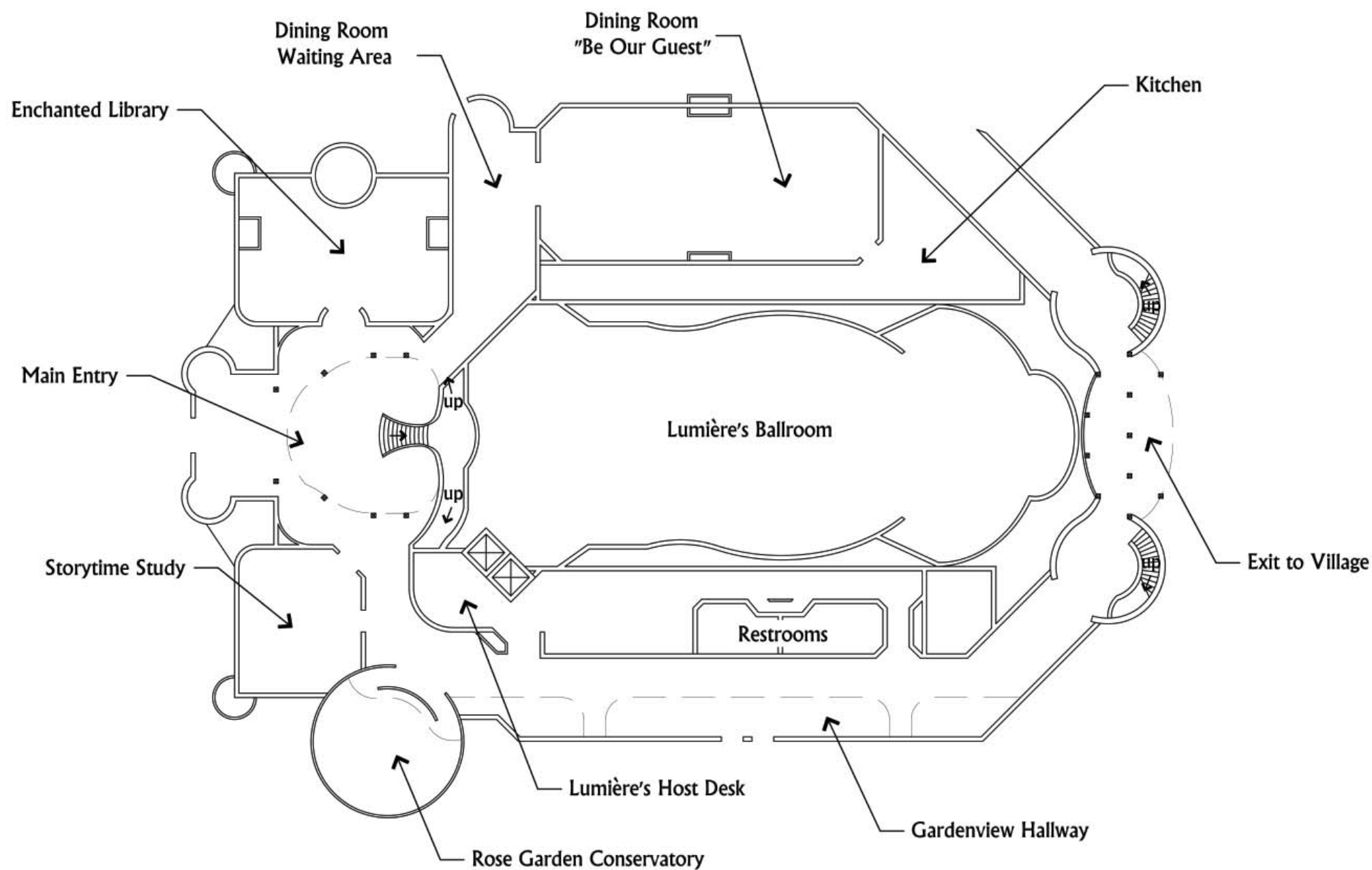

-Site Plan-



-1st Floor-

Le Château de la Belle et la Bête

Layout

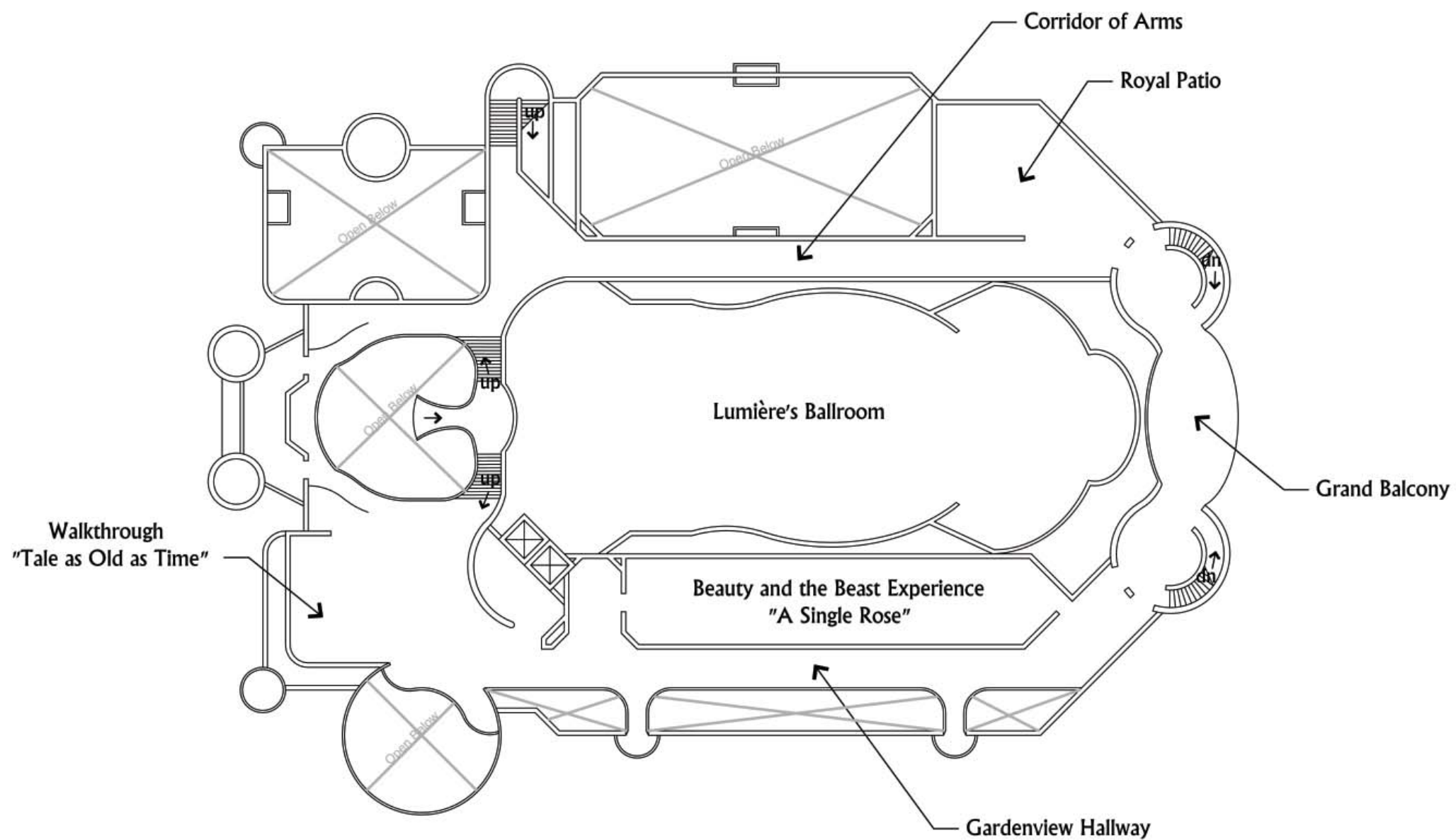

-2nd Floor-

Le Château de la Belle et la Bête

Layout

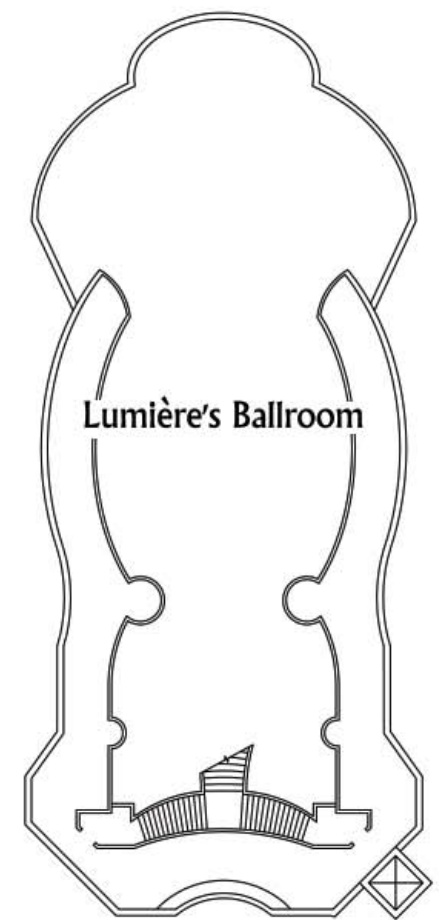
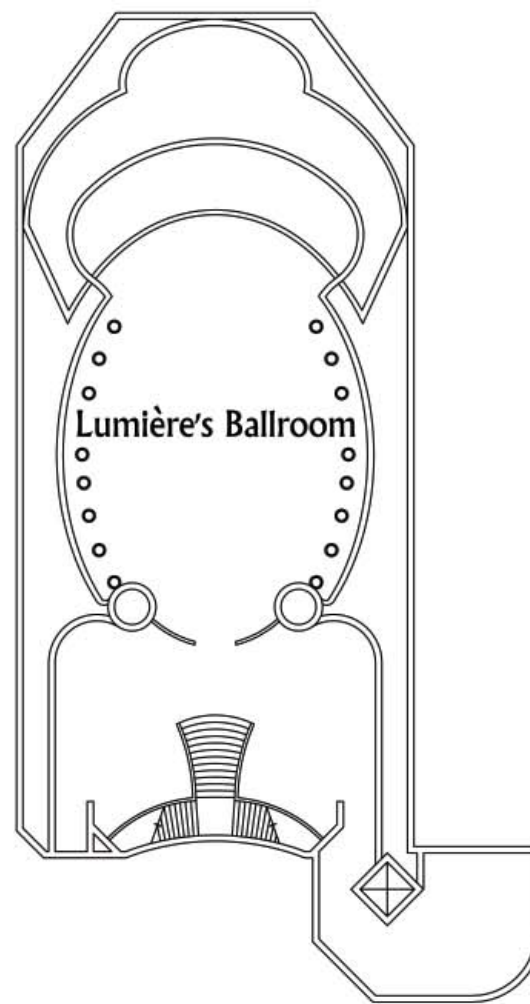
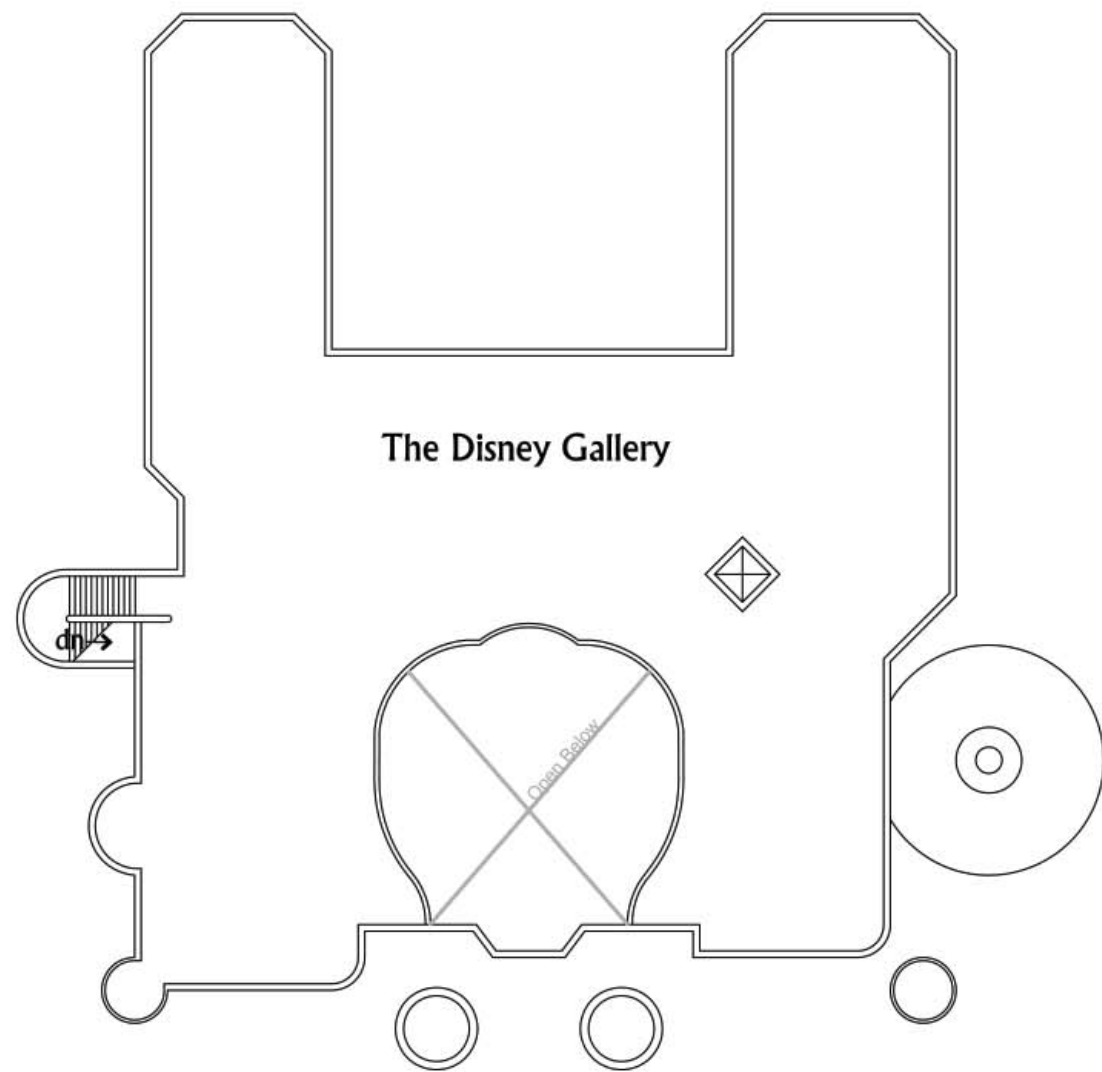

-3rd Floor-

-Ballroom-

Front Elevation (South)

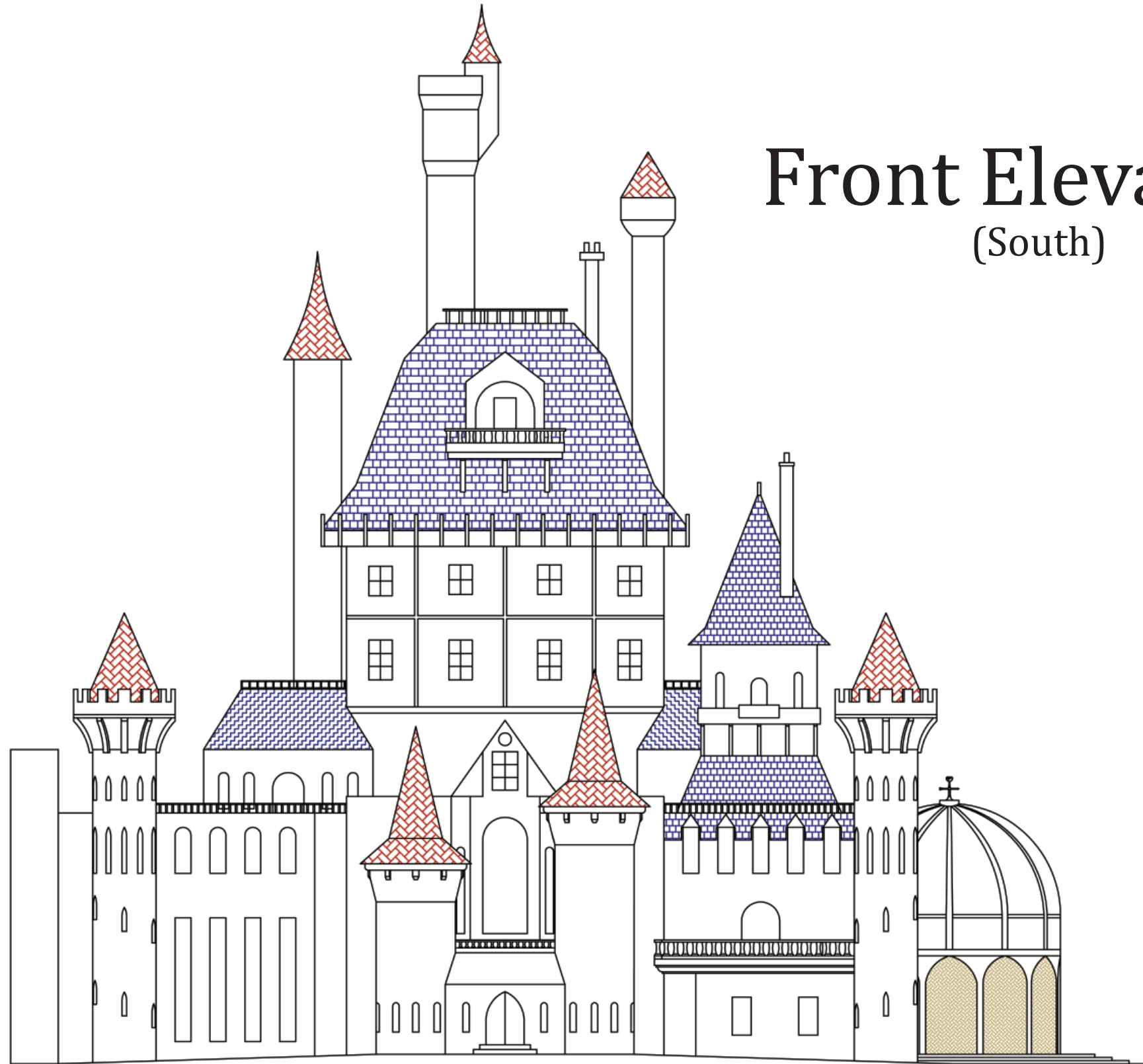

Le Château de la Belle et la Bête

Layout

1st Floor

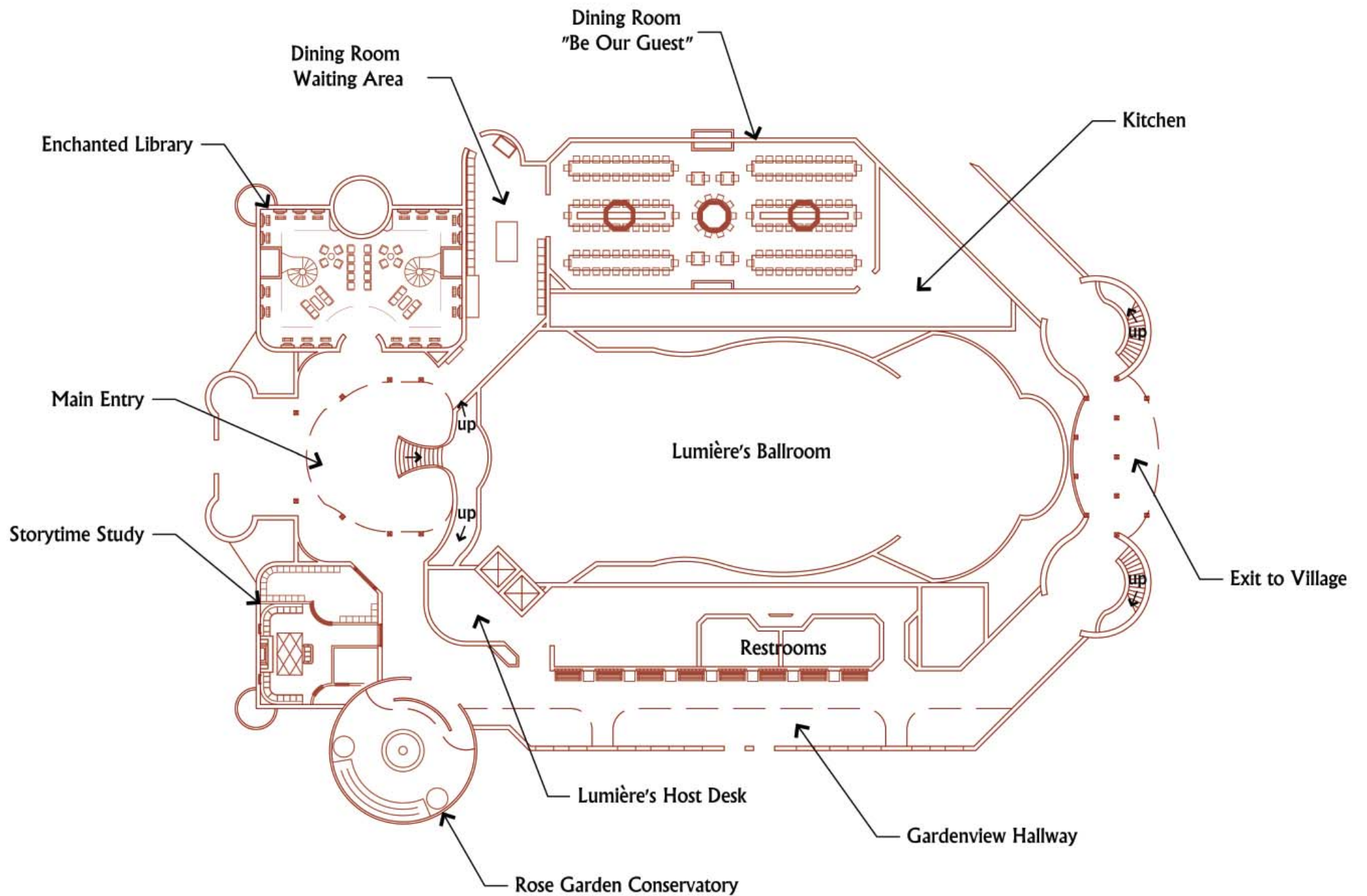

Main Entry

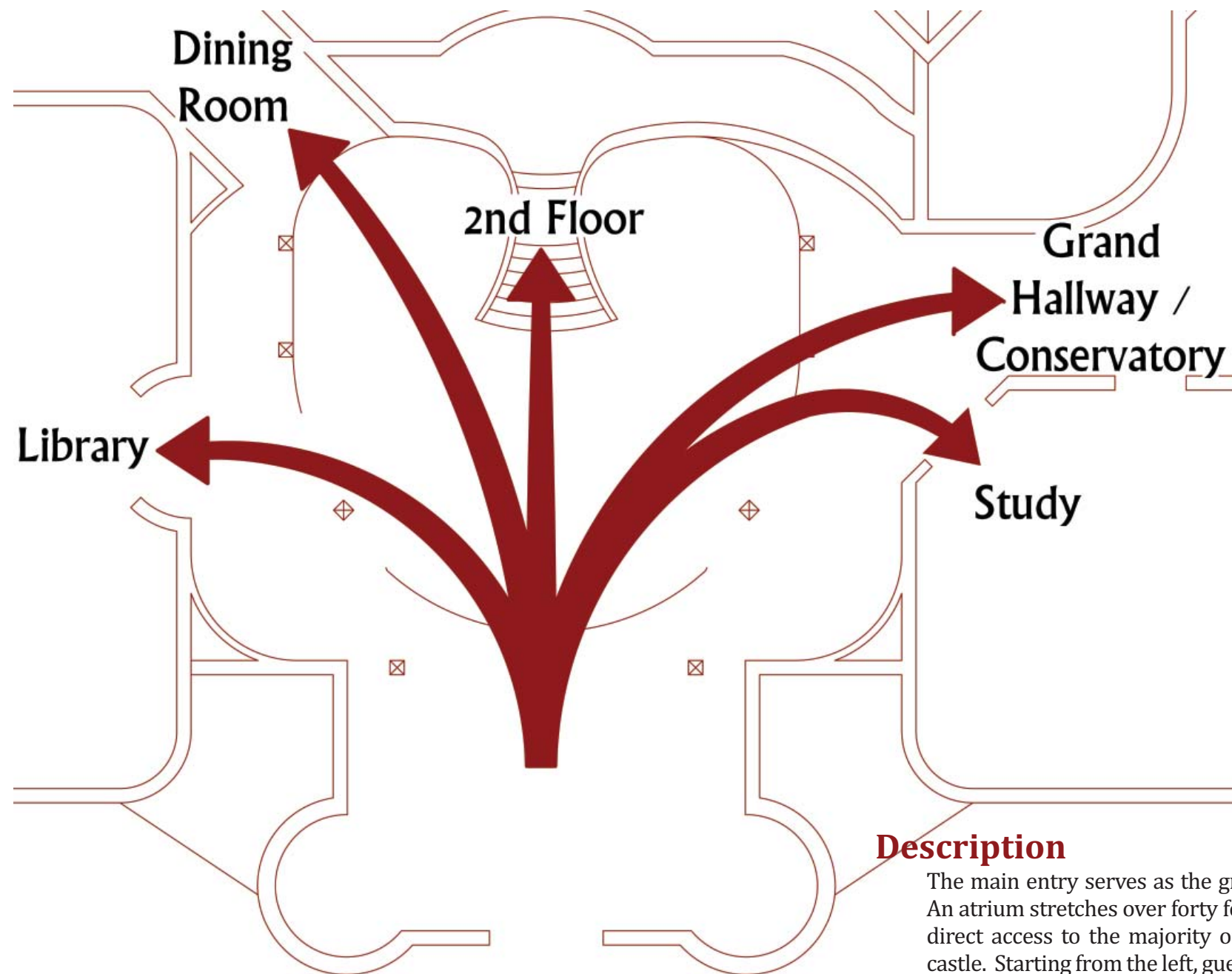

Description

The main entry serves as the grand entrance to the castle. An atrium stretches over forty feet above. The entry grants direct access to the majority of the attractions inside the castle. Starting from the left, guests may visit the Enchanted Library, Be Our Guest Dining Room, stair access to the 2nd floor, the Gardenview Hallway, Rose Garden Conservatory, and the Storytime Study.

Storytime Study

1.2



Description

Twice each hour in the study a story is read. The guests line up in the waiting area until allowed into the main room. There are benches and room on the carpet to sit and listen to the story. After the guests are situated, Belle enters from a hidden door in the wall. While Belle reads a story the Beast enters and the room chills, the lights dim, and a breeze sweeps through the room causing the fire to go out.



Le Château de la Belle et la Bête

1st Floor

Study Details

1.3

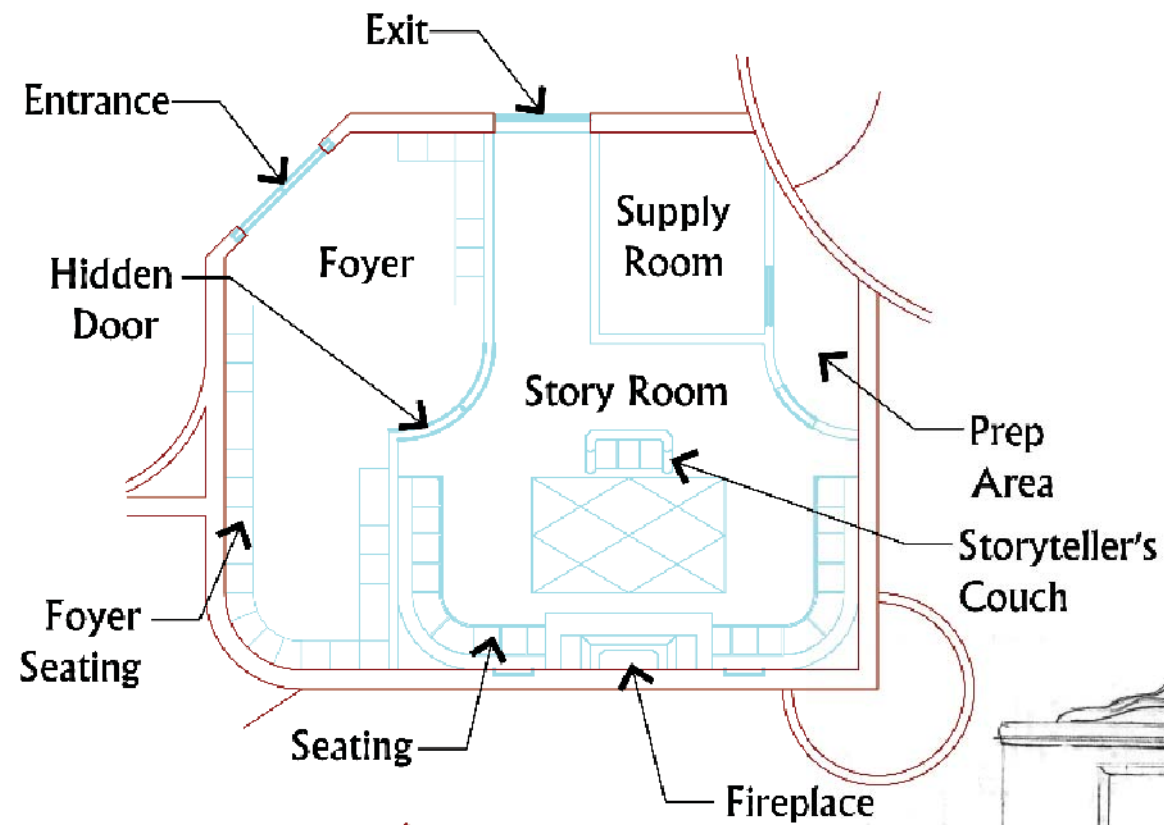

Bench model



Sample Carpet

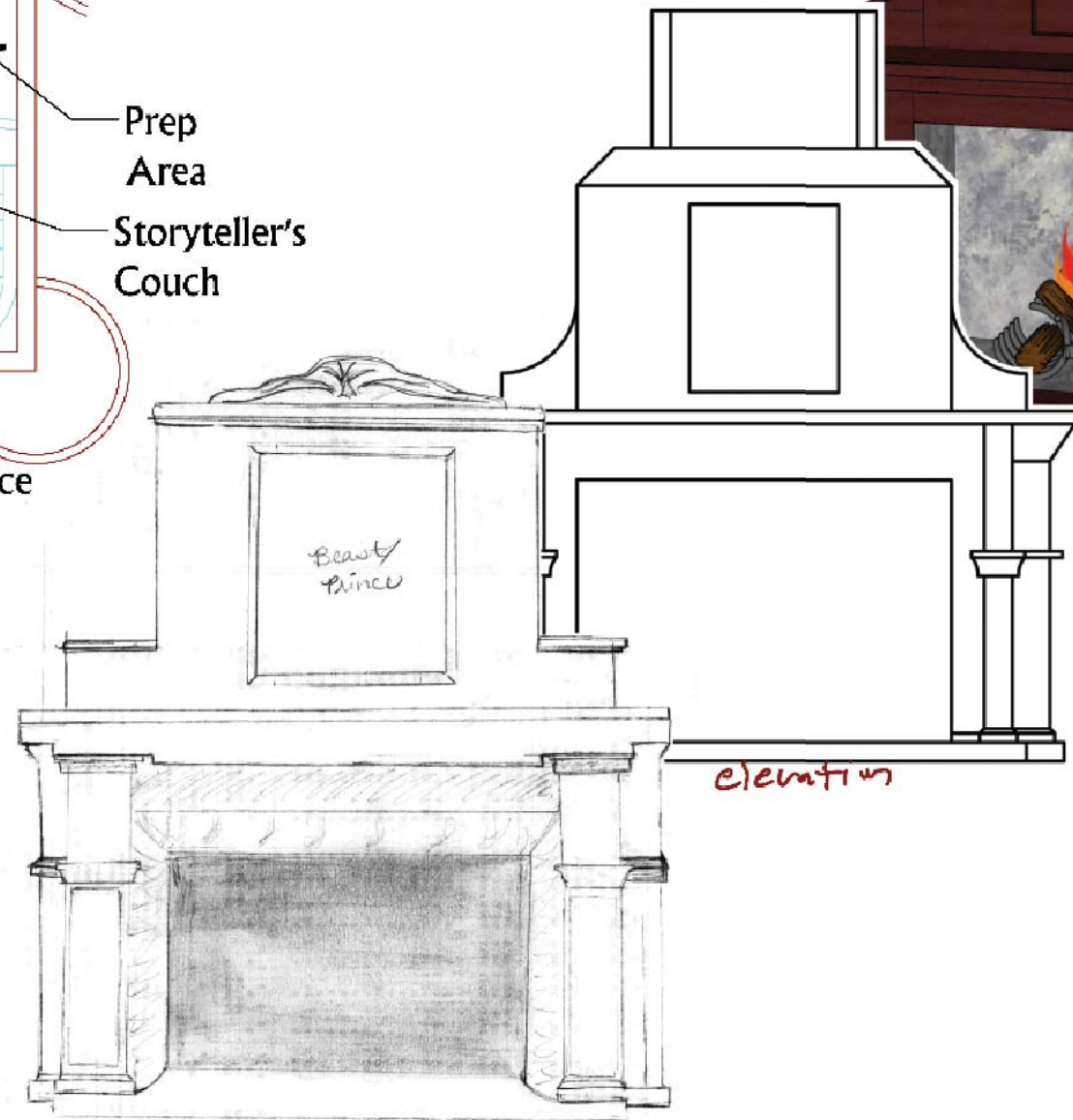

Model

Rose Garden Conservatory

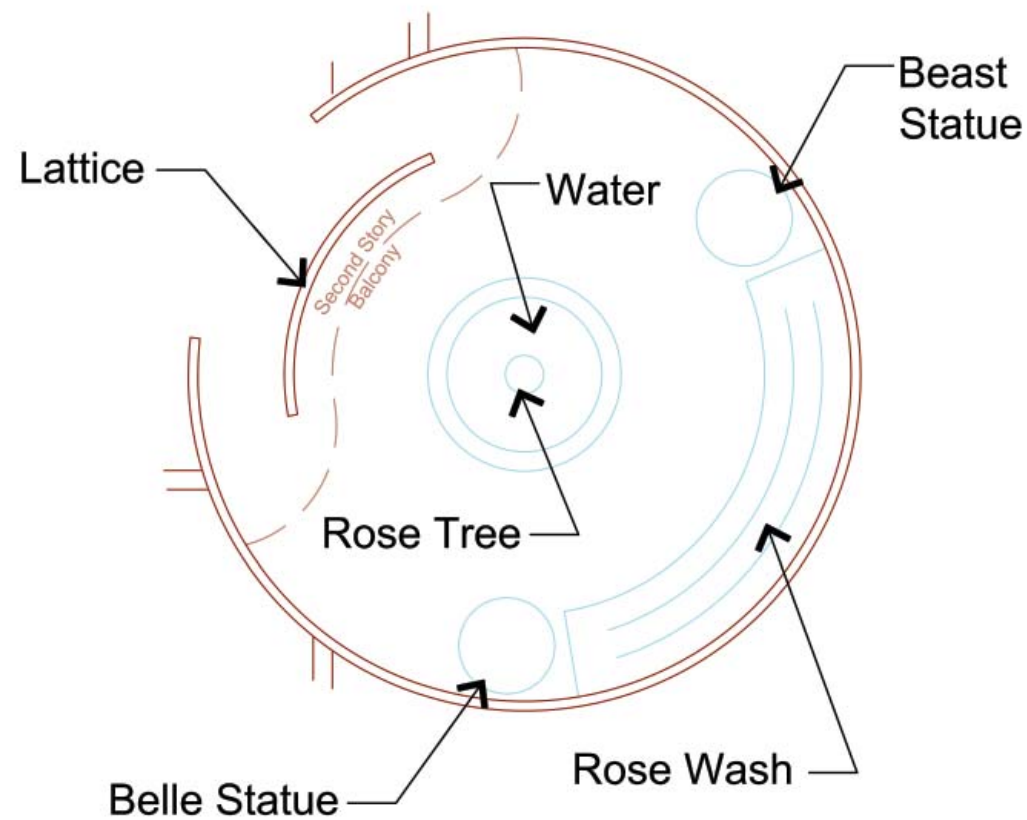

Description

The conservatory is a quiet, peaceful room that displays the wonder and beauty of the rose. A rainbow of color is created in the Rose Wash as the varieties of the rose family are showcased. This room will be a place of education, informing the guests about the joys of horticulture.

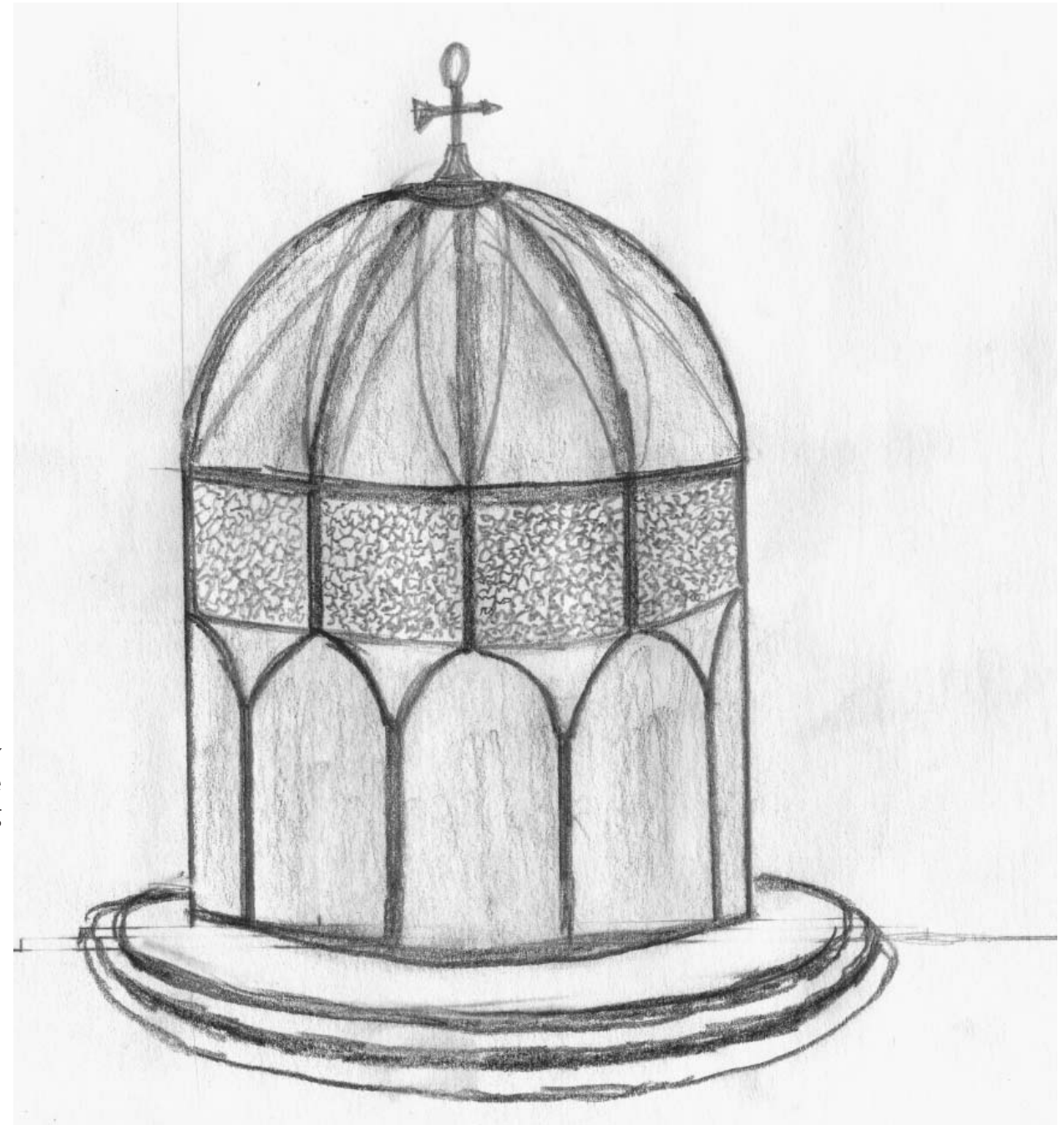



Conservatory

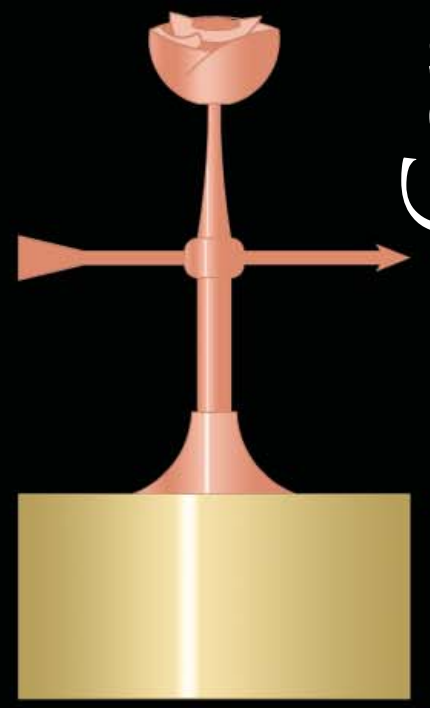

Enchanted Library

Description

The Enchanted Library is an interactive room with consoles located throughout the area. These consoles allow the guest to view a magic mirror, create a story, discover their character profile, and more.

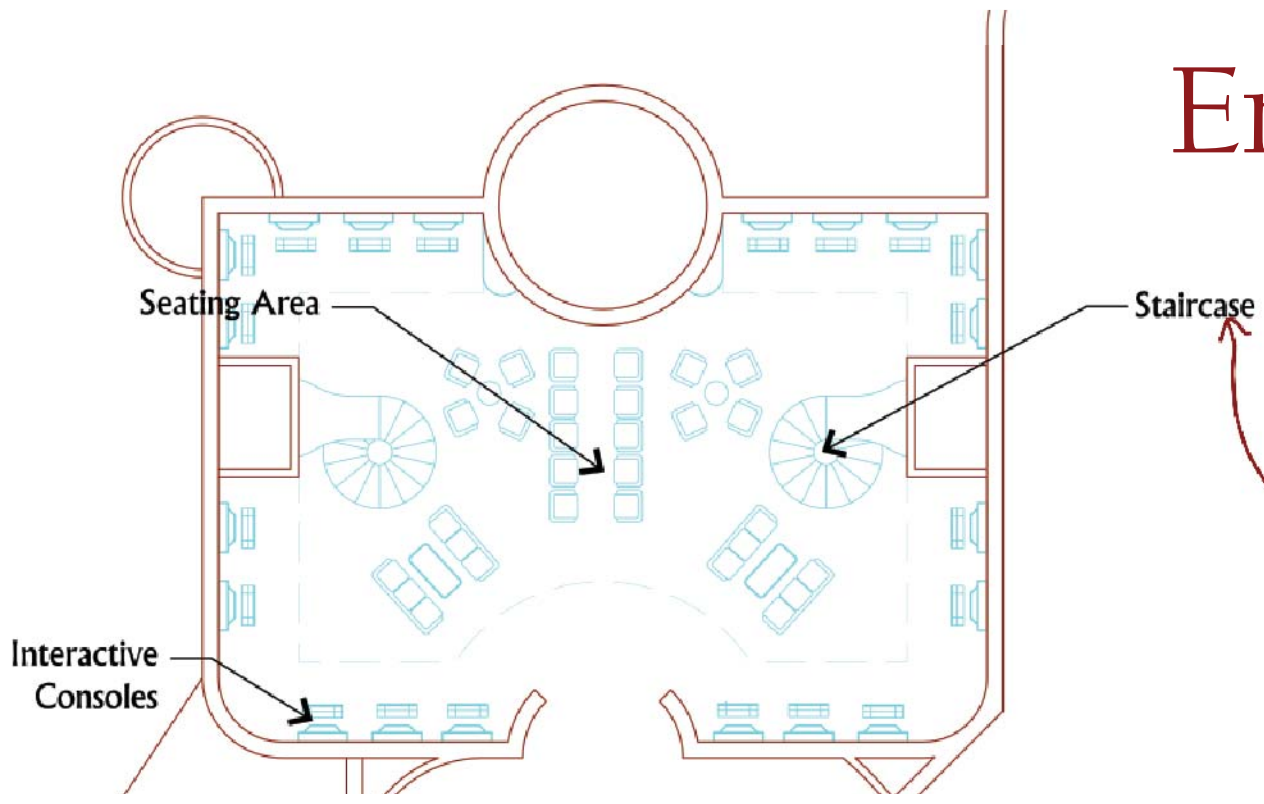

Consoles



Guests emails stories home

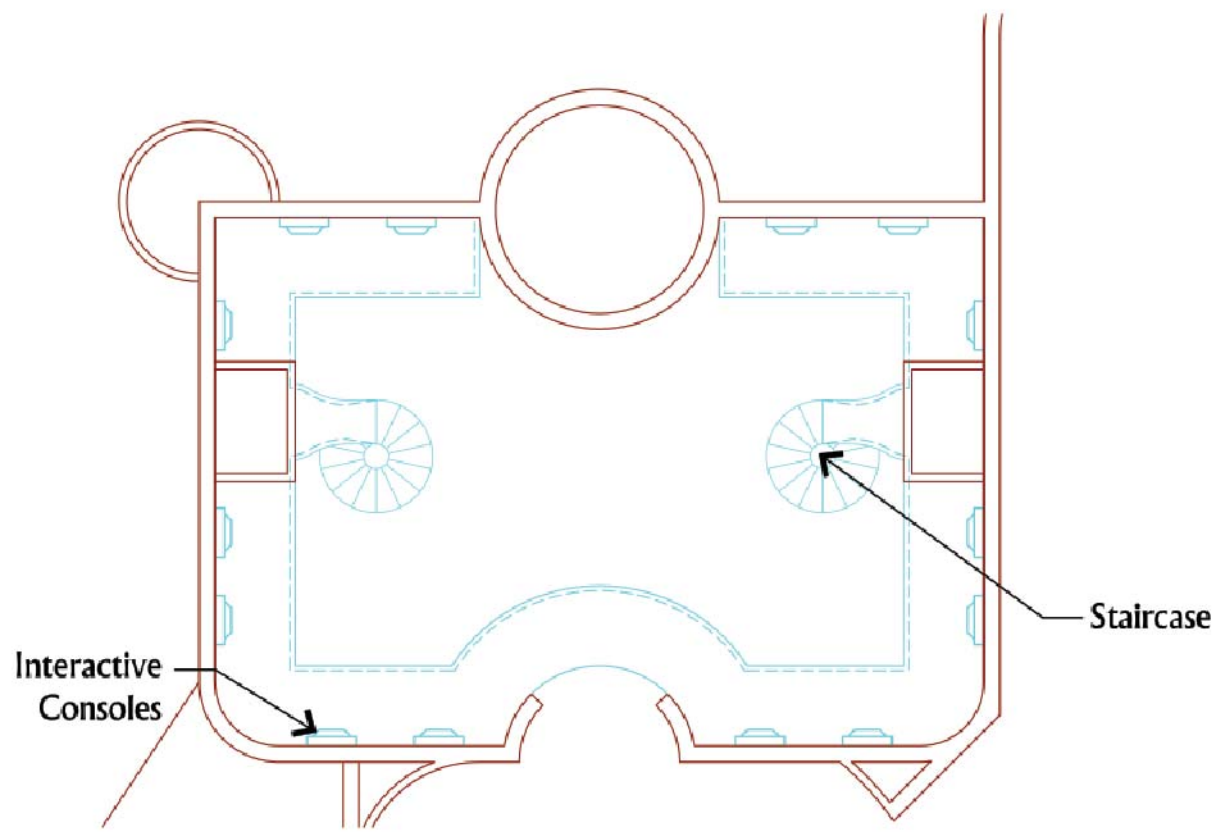
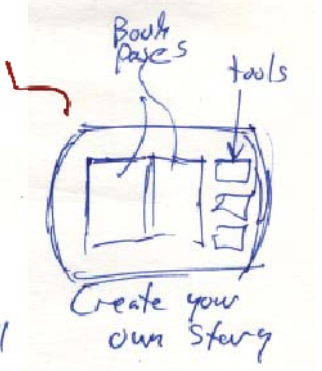
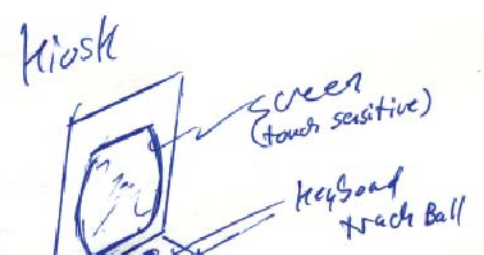
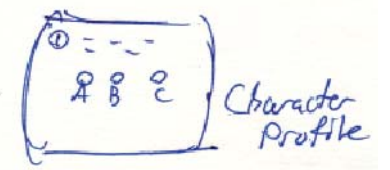

Be Our Guest (dining room)

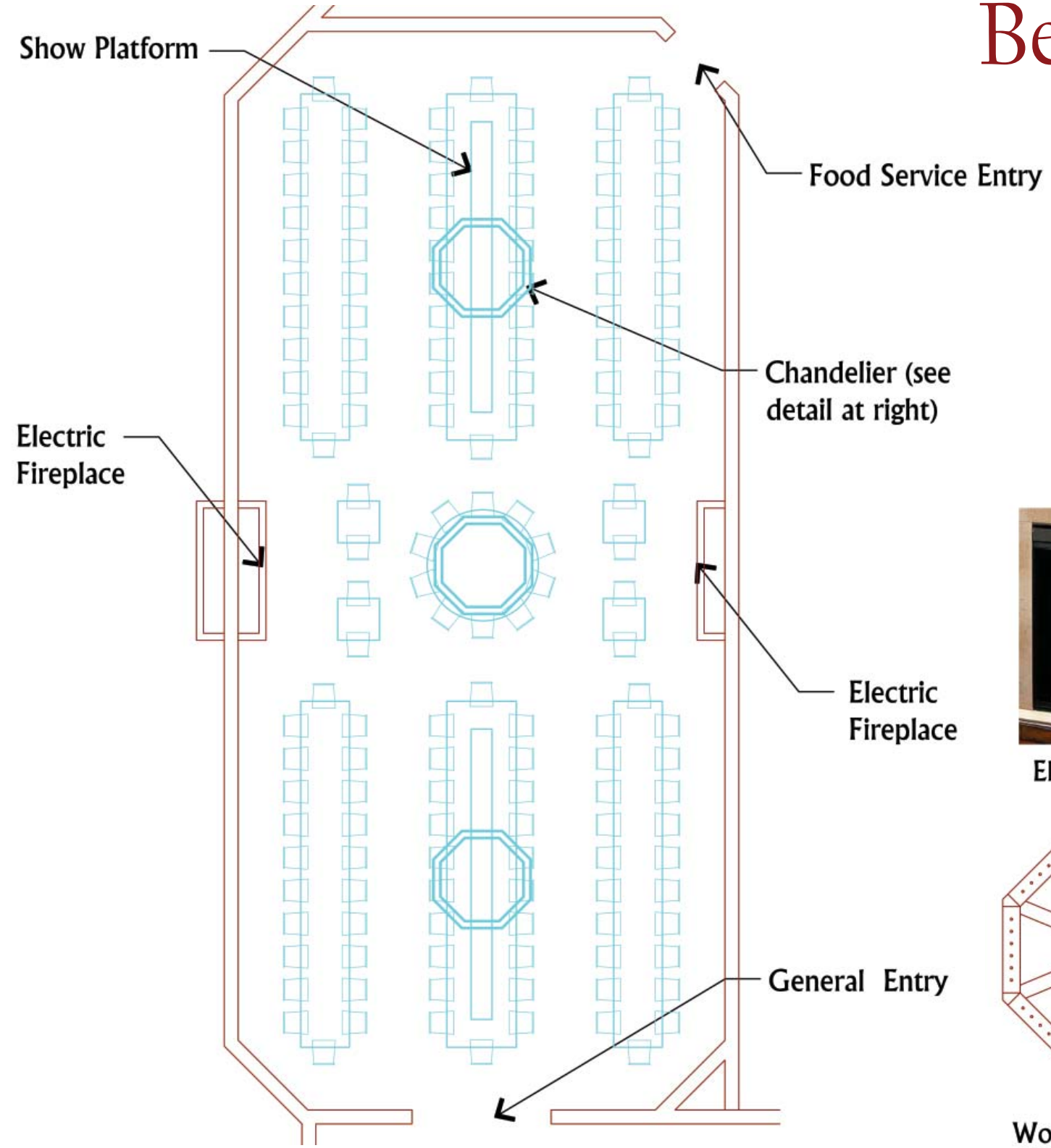

Description

The dining room is a moderate, sit-down restaurant (food service styled after Ohana's). Every half hour there is a show that emulates Be Our Guest. All characters and props are hidden in the tables and during the show they emerge at various points. Lumiere, Cogsworth, and Mrs. Potts, are among the characters used. Large fireplaces flank each side of the dining room and feature a holographic fire effect.



Electric Fireplace

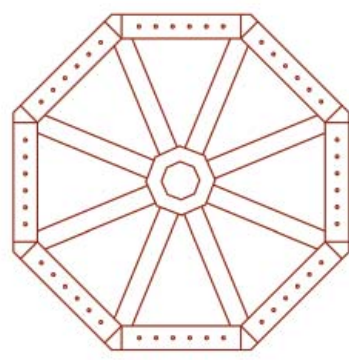

Plan of Wooden Chandelier

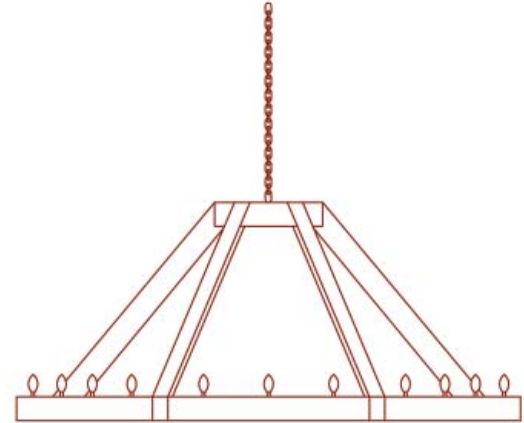

Section of Wooden Chandelier

Show Ideas

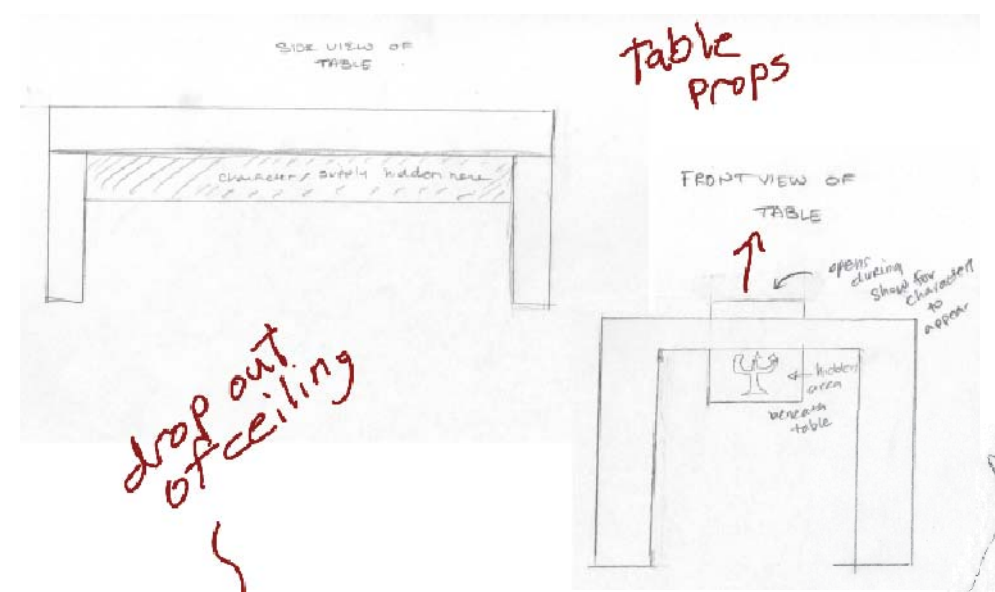

drop out of ceiling

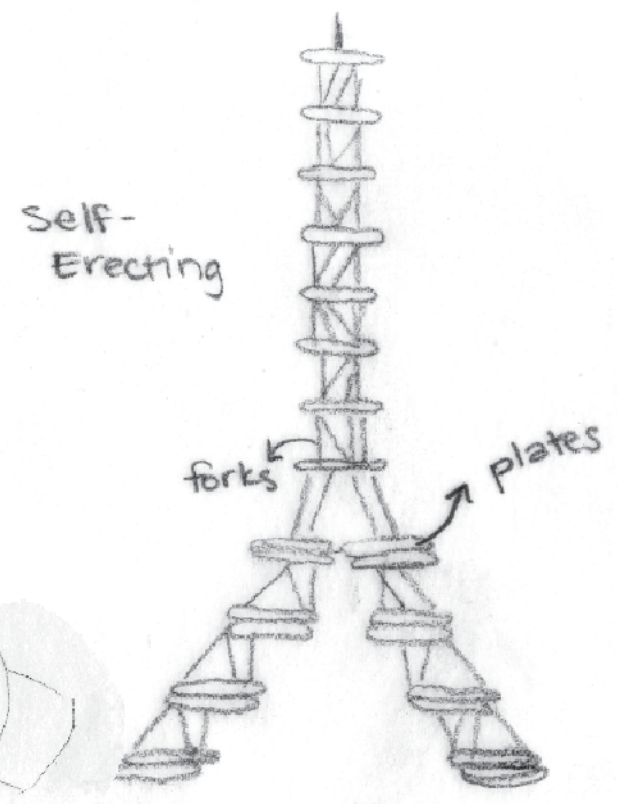
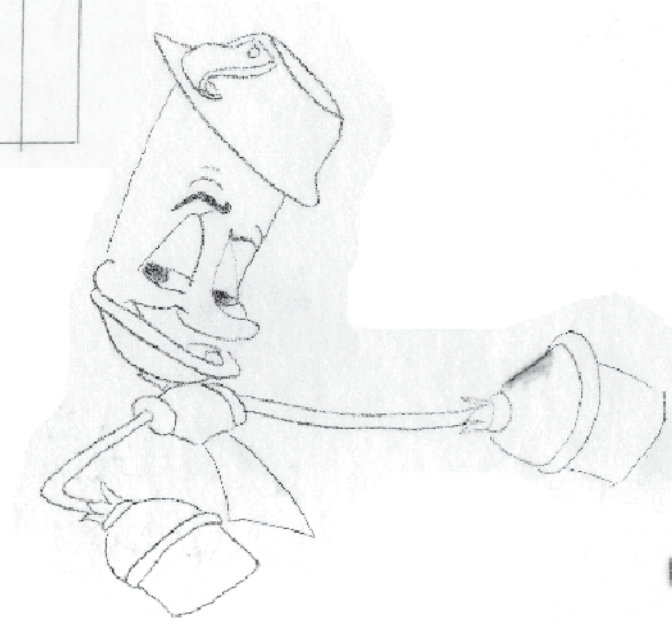

Eiffel Tower -> Dining Room Show

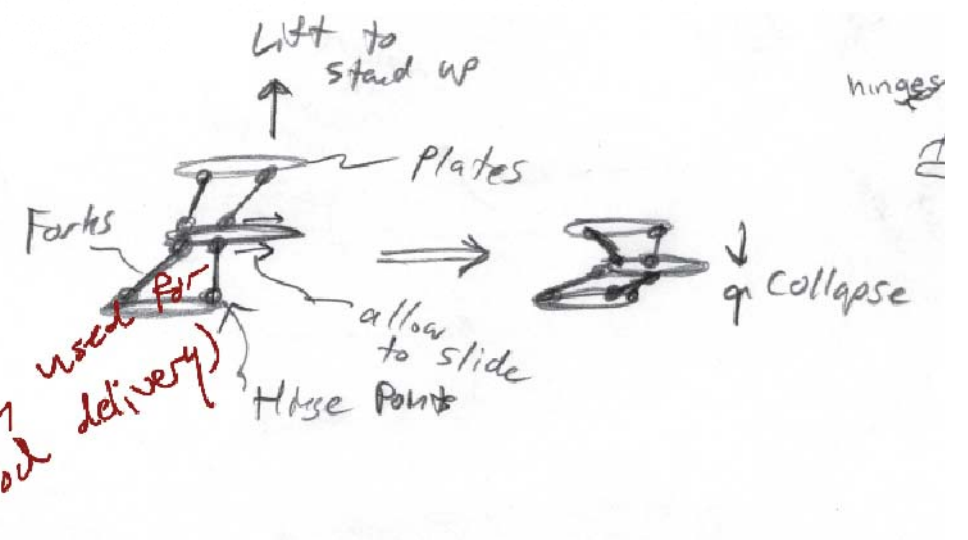

Cart (possibly food delivery) used for

Dining Room Show

Dining Room Waiting Area



table

zzz
sleeping noises



use this style

table with Cogsworth & Lumiere

cabinets with sleeping teacups

seating area

entry arch + columns

use this floor for dining room

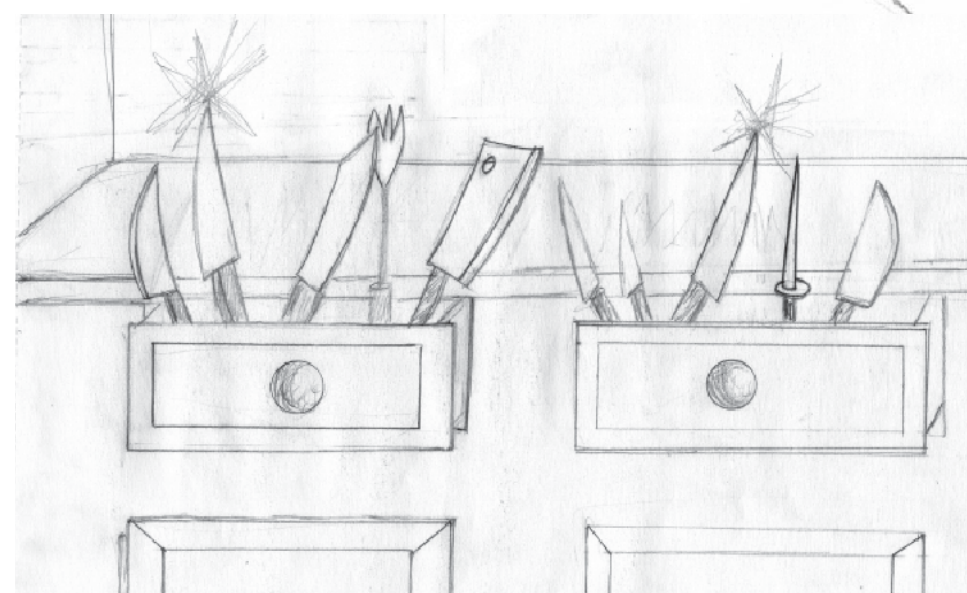

seating area

cutting board

stove



Gardenview Hallway

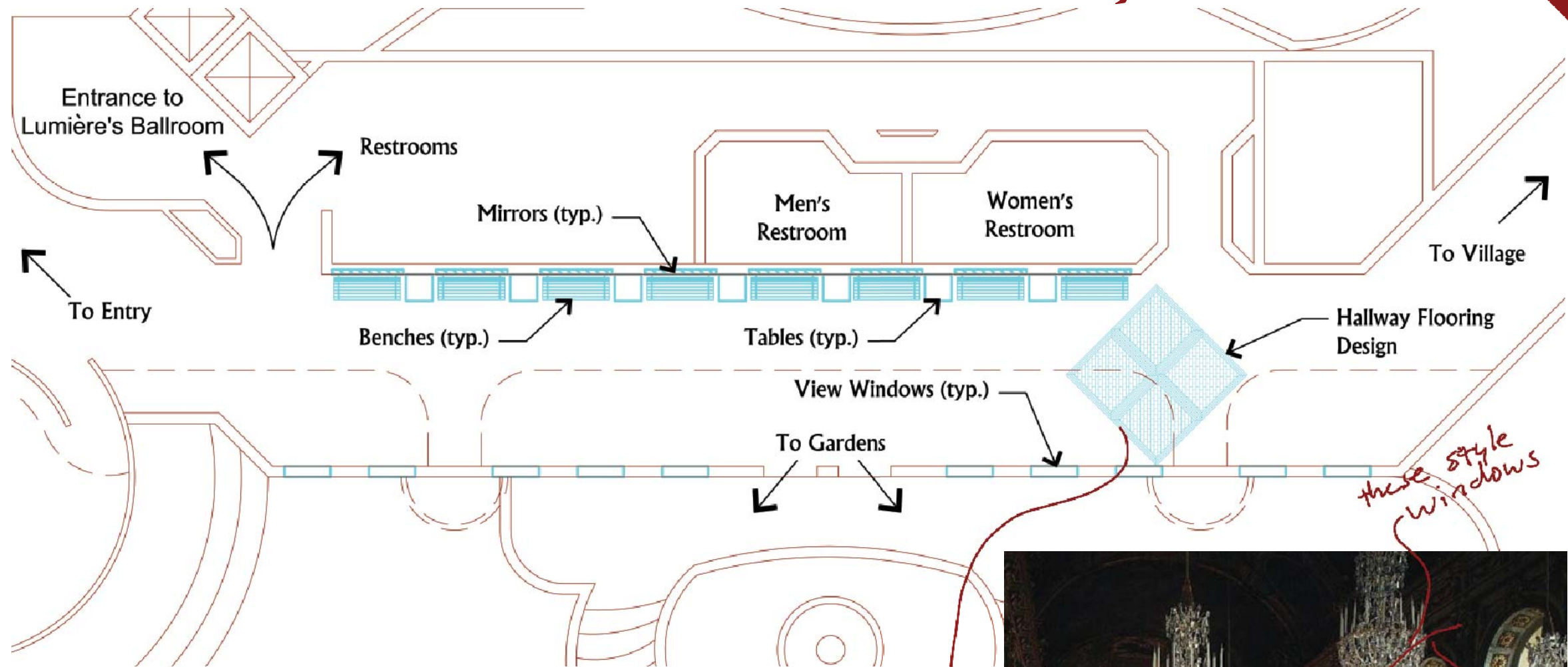

Description

This grand hallway is modeled after the Hall or Mirrors at the palace in Versailles, France. The hallway is very spacious, with tall windows climbing to the ceiling. The hallway is tiered with the second floor open to the first floor below. On the second floor, walkways extend to the exterior wall where two balconies overlook the Royal Gardens.

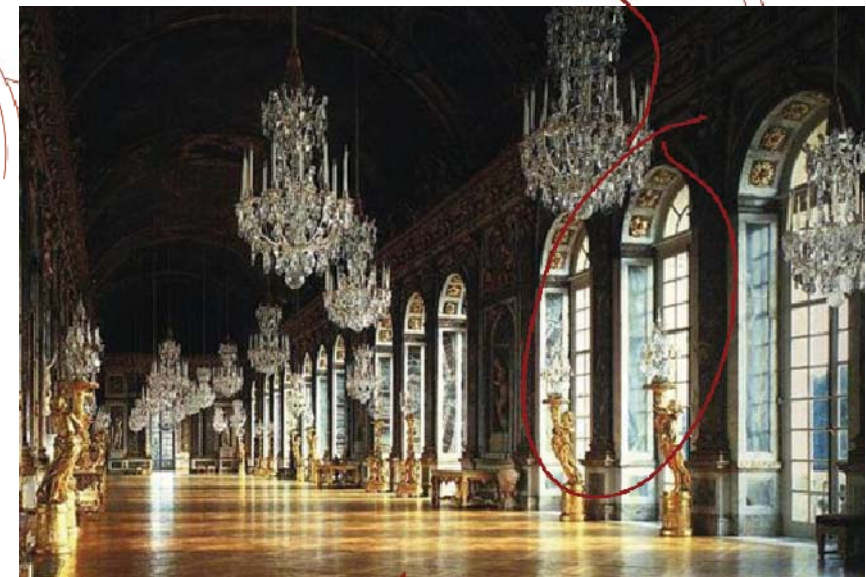
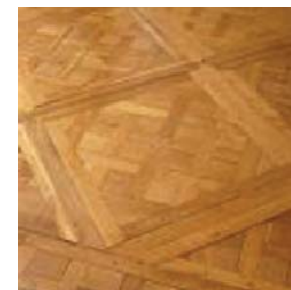

versaille

2nd Floor

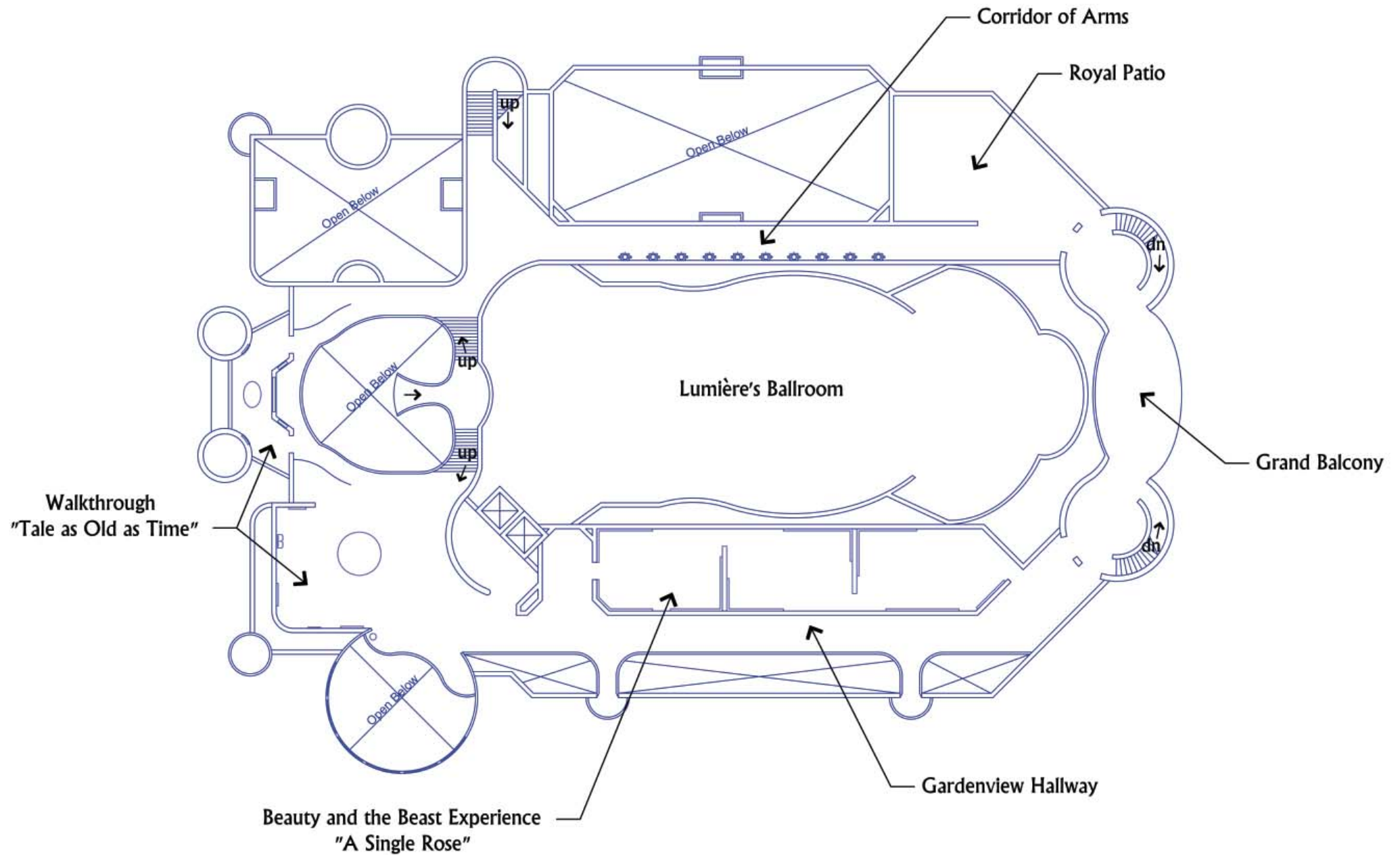

Tale as Old as Time

Walkthrough

Description

The Beauty and the Beast Walkthrough displays the story through paintings, stained glass, tapestries, statues, mosaics, and metal work. Books along the way narrate the story.

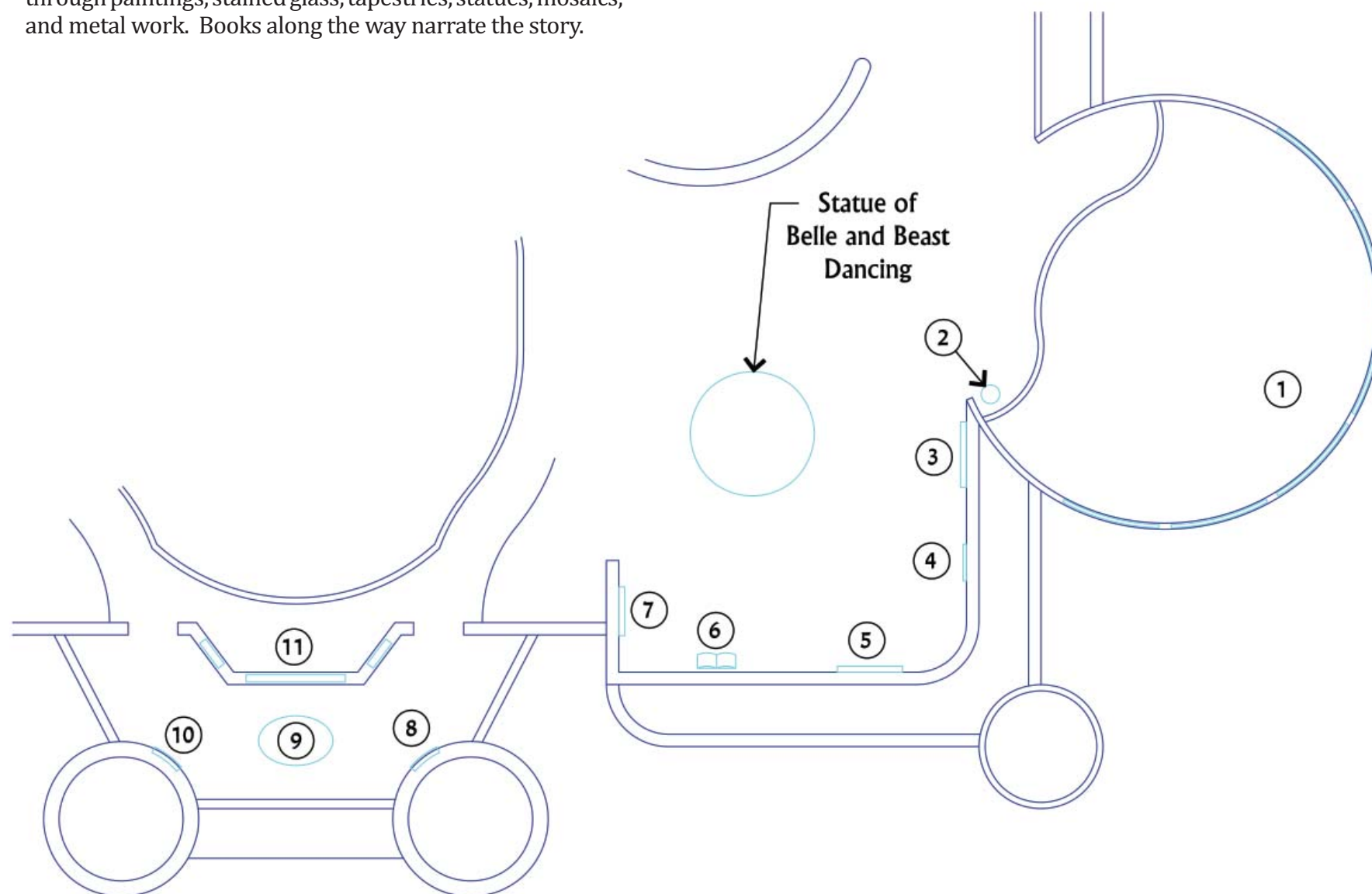

Items

1. Stain Glass along Conservatory (prologue)
2. Table with rose under glass
3. Painting – Belle
4. Sepia Print – Beast and Belle in the tower
5. Glass Mosaic – Lumière (Be Our Guest)
6. Picture – Belle, Beast, and other characters (sample book)
7. Tapestry – Belle and Beast dancing
8. Metal Work – Cogsworth (metal plate inlaid into tower at balcony)
9. Statue – Beast and Gaston fighting
10. Metal Work – Lumière (metal plate inlaid into tower at balcony)
11. Stain Glass – ending scene (front window of castle)

Walkthrough Storyboard



Prologue Plays - viewed from conservatory balcony

Table



Painting



Sepia print



Mosaic



Book Sample



Tapestry



Metal Plate



Statue



Metal Plate

A Single Rose

The Beauty & the Beast Experience

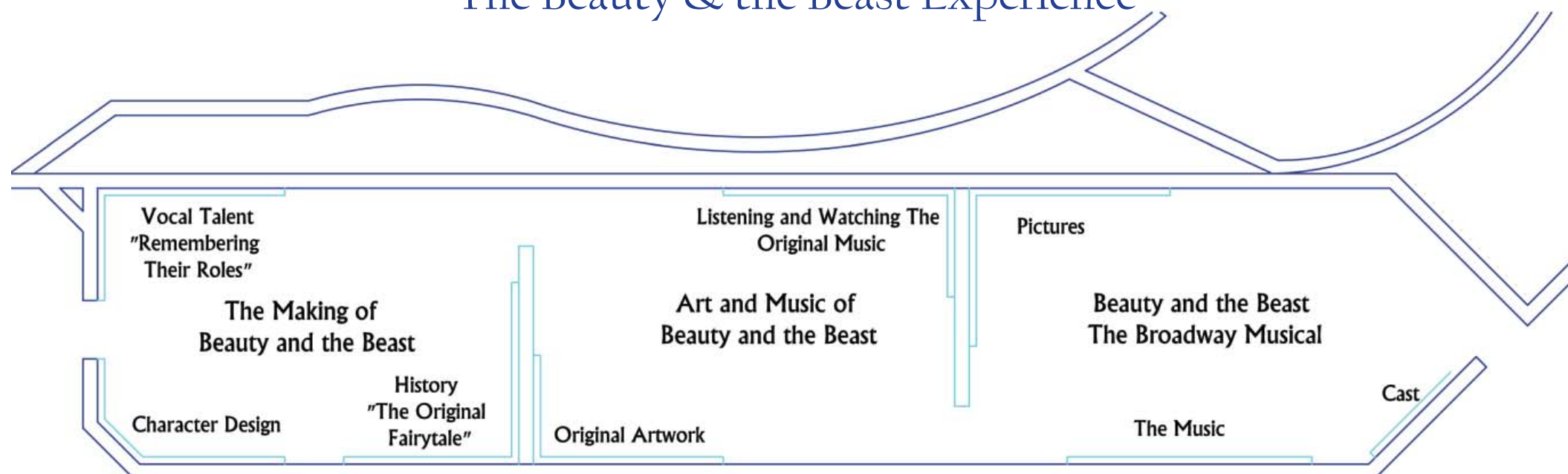

Description

A Single Rose is a gallery that showcases the wonderful art, music, and talent that went into creating the movie Beauty and the Beast. The three sections are: The Making of Beauty and the Beast, Art and Music, and the Broadway Musical. This venue will be similar to the exhibits at the Disney Animation Building.

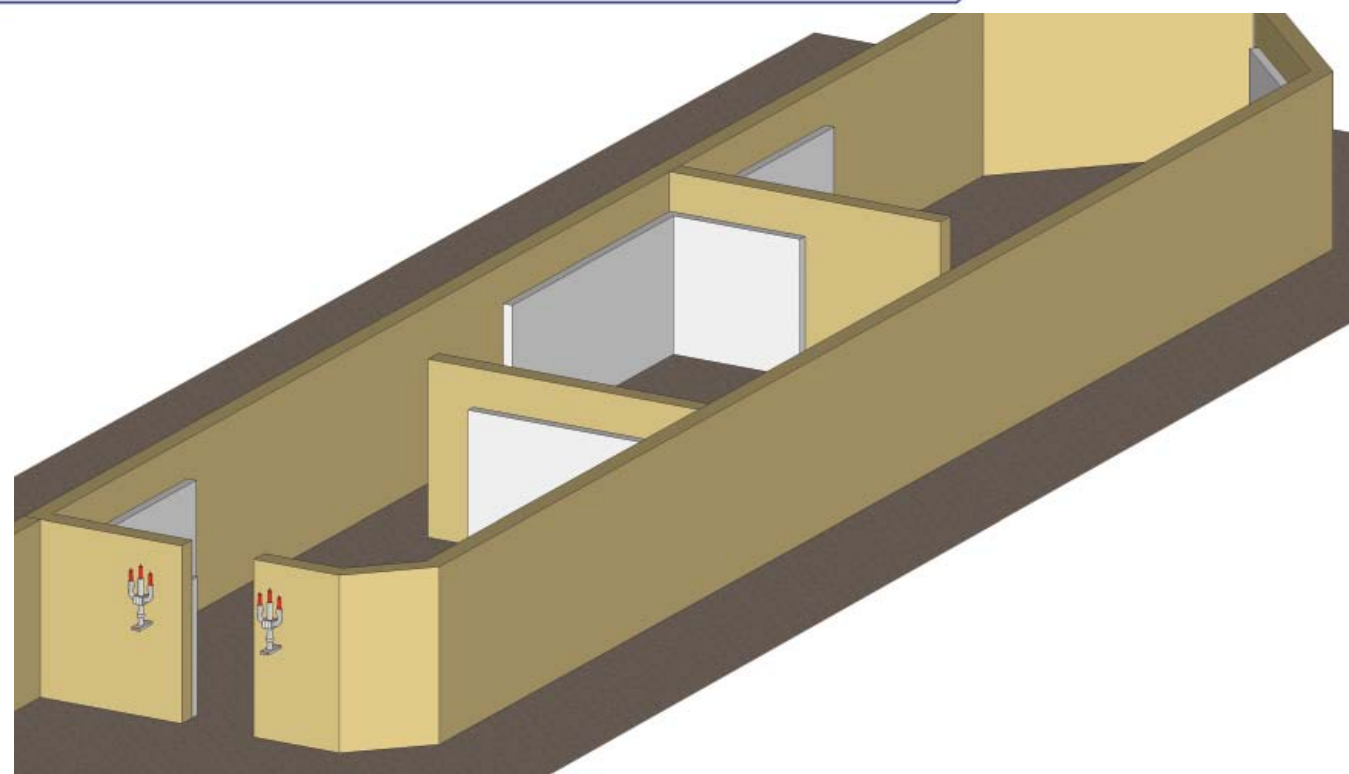

Grand Balcony & Stairs

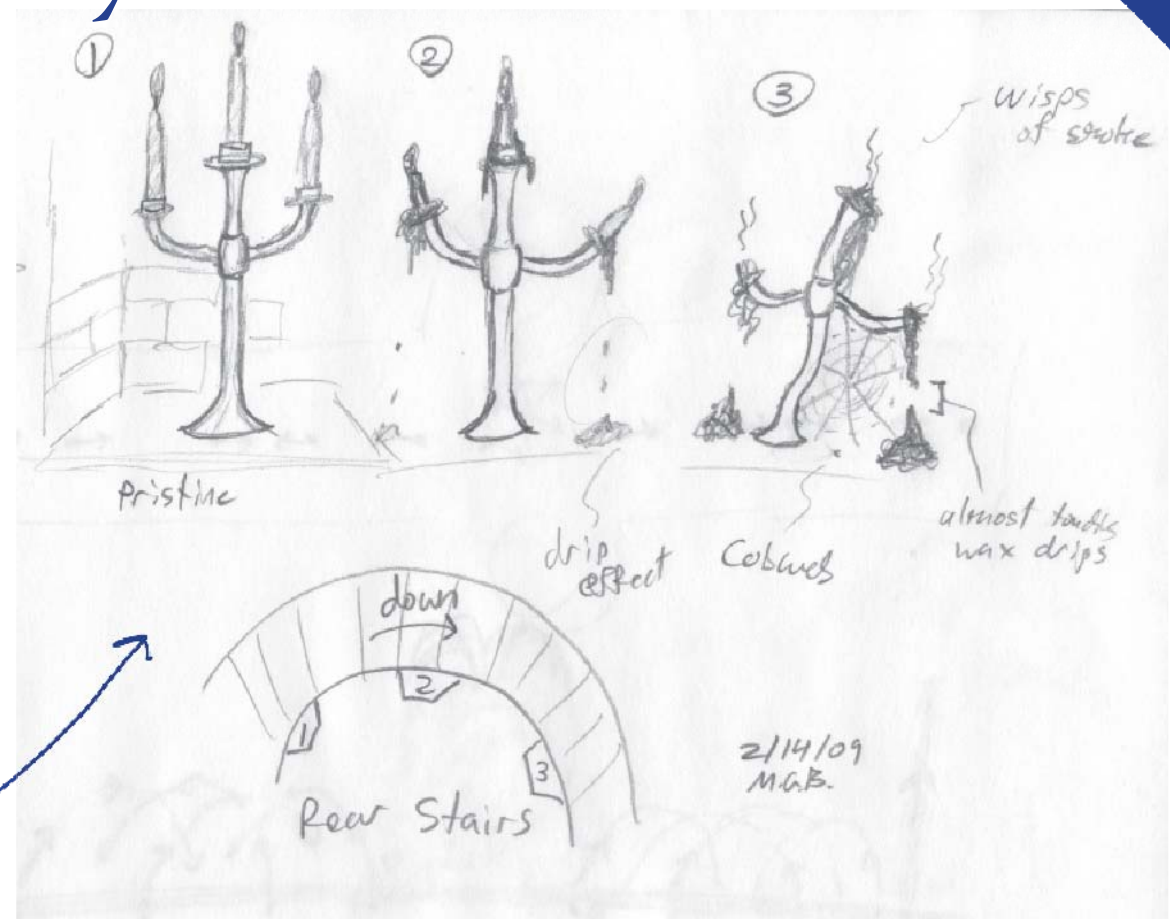
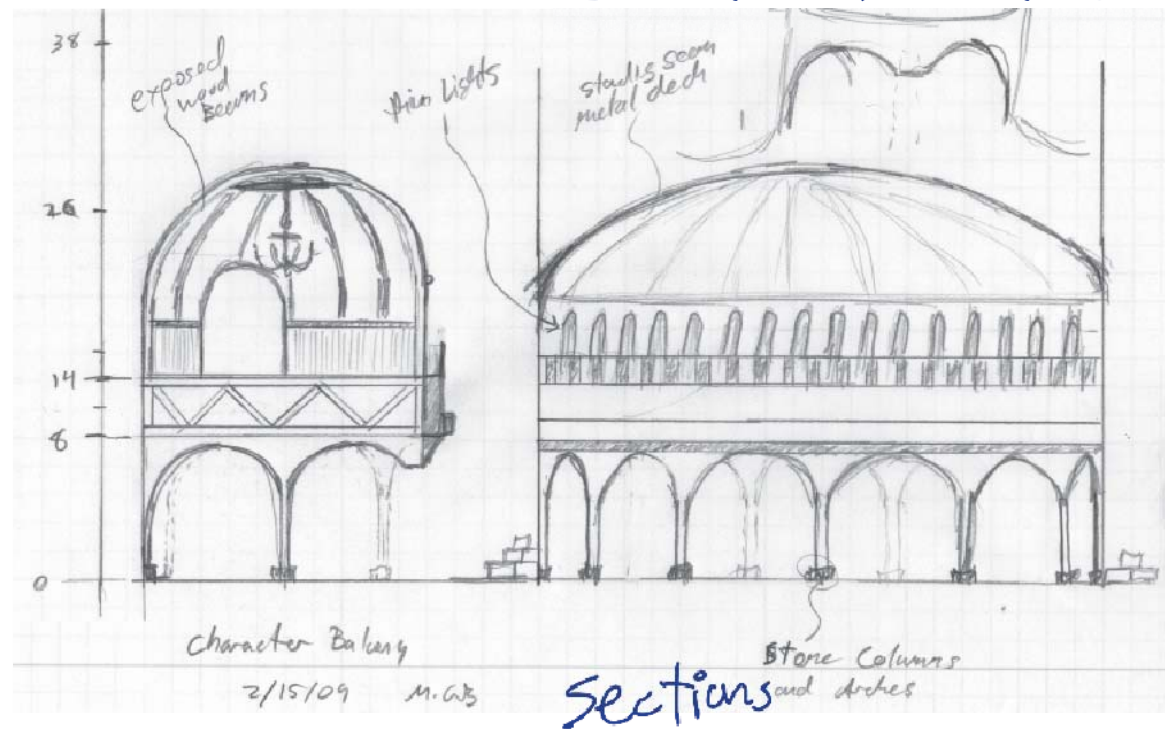

Inset Candelles

Description

This ornate pavilion is where the guests will have an opportunity to meet their favorite characters. Paintings of princesses are hung on the walls and the windows will look out over the village and Fantasyland offering brilliant views.

At the end of each hallway there is a spiral staircase. As the guests walk around the stairs they see three candleholders which progressively become more decrepit.



Physical Sample

Corridor of Arms

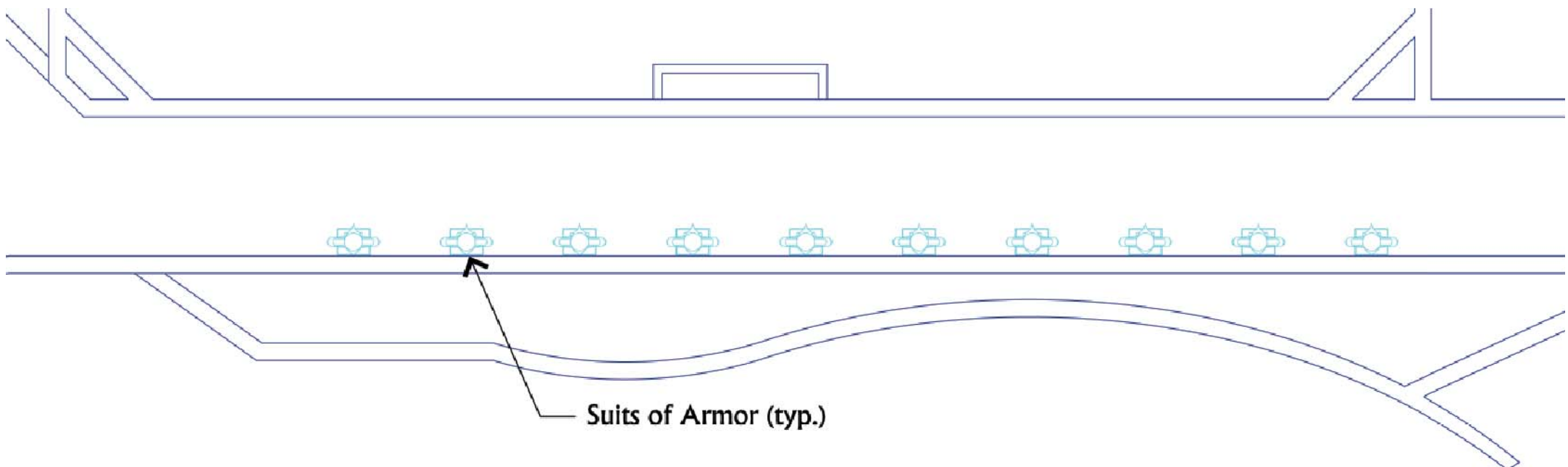

Description

The Corridor of Arms is a less traveled section of the castle with a subtle surprise. Modeled after the memorable scene in the movie where the suits of armor track Belle's movement, as guests walk along the hallway the suits follow their movement.

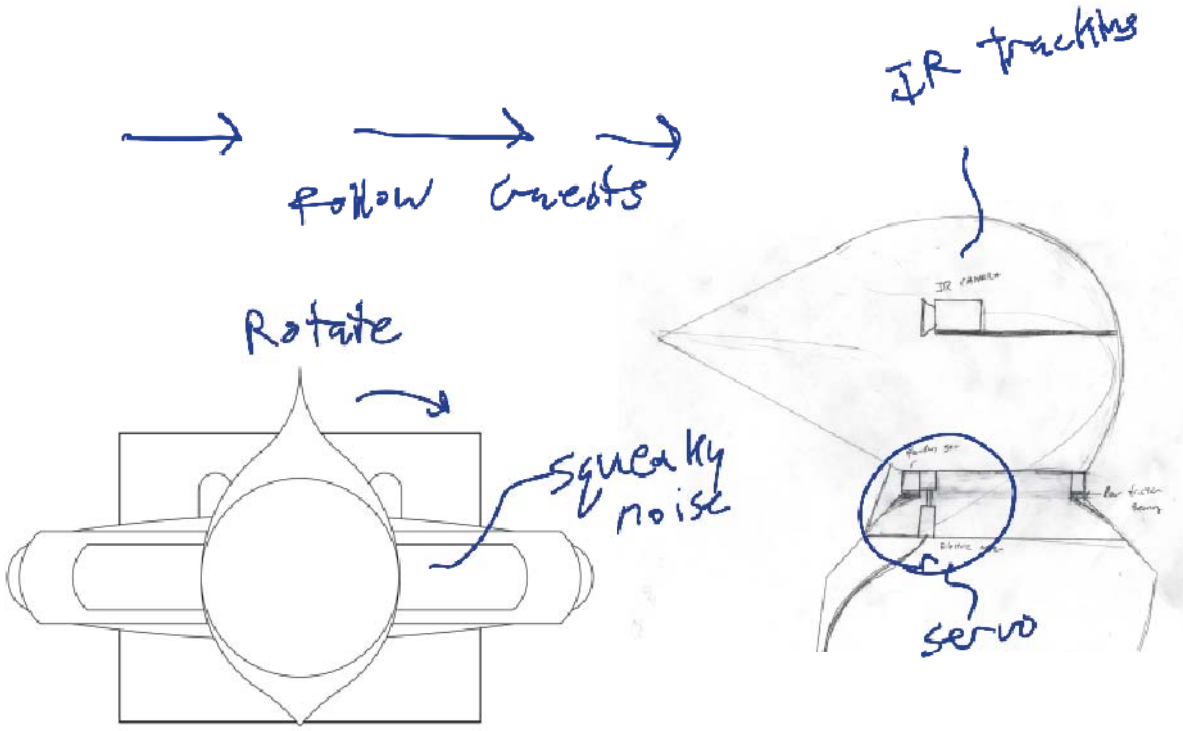

3rd Floor

(Disney Gallery)

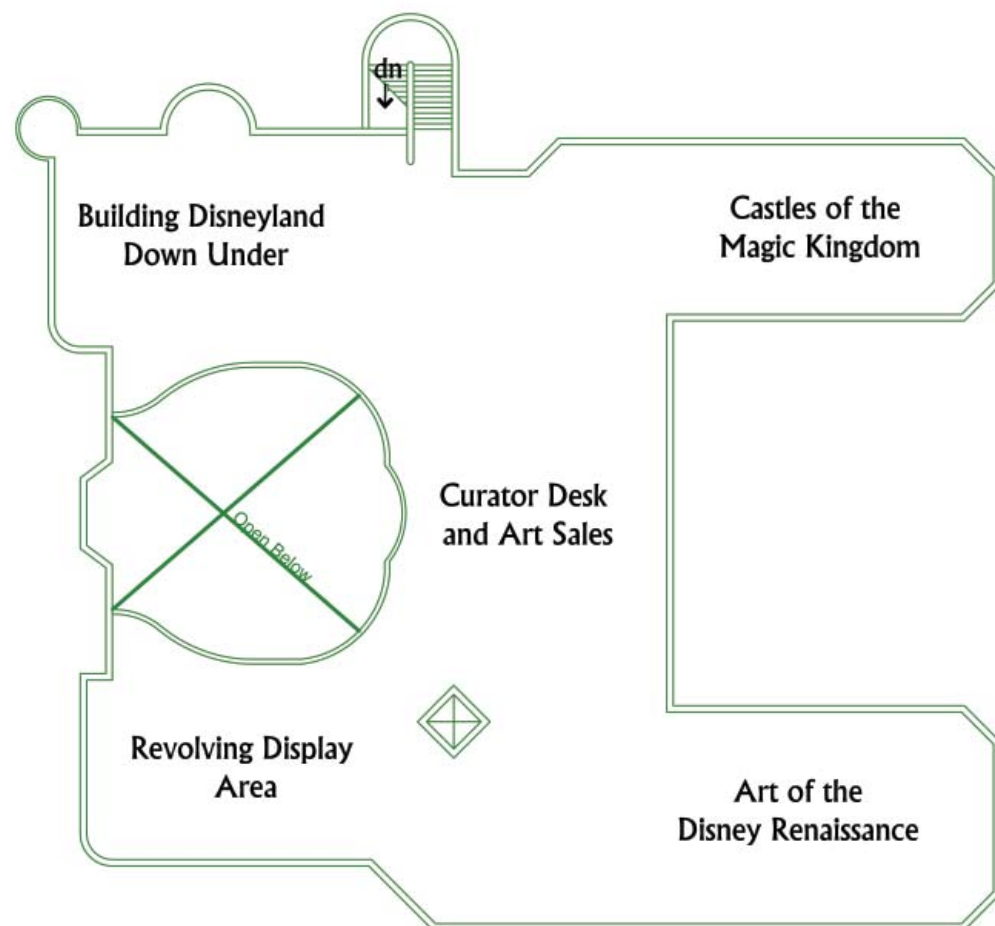

Description

The third floor of the castle serves as one large Disney Gallery. There are several sections in the gallery which display formal art and modern design concepts. The sections are: Castles of the Magic Kingdom (art work of the various Disney Castles), Art of the Disney Renaissance (works from the modern Disney classics), Building Disneyland Down Under (models, art, and concepts for Disneyland Sydney), and a Revolving Art Section (changing artwork).

Lumière's Ballroom

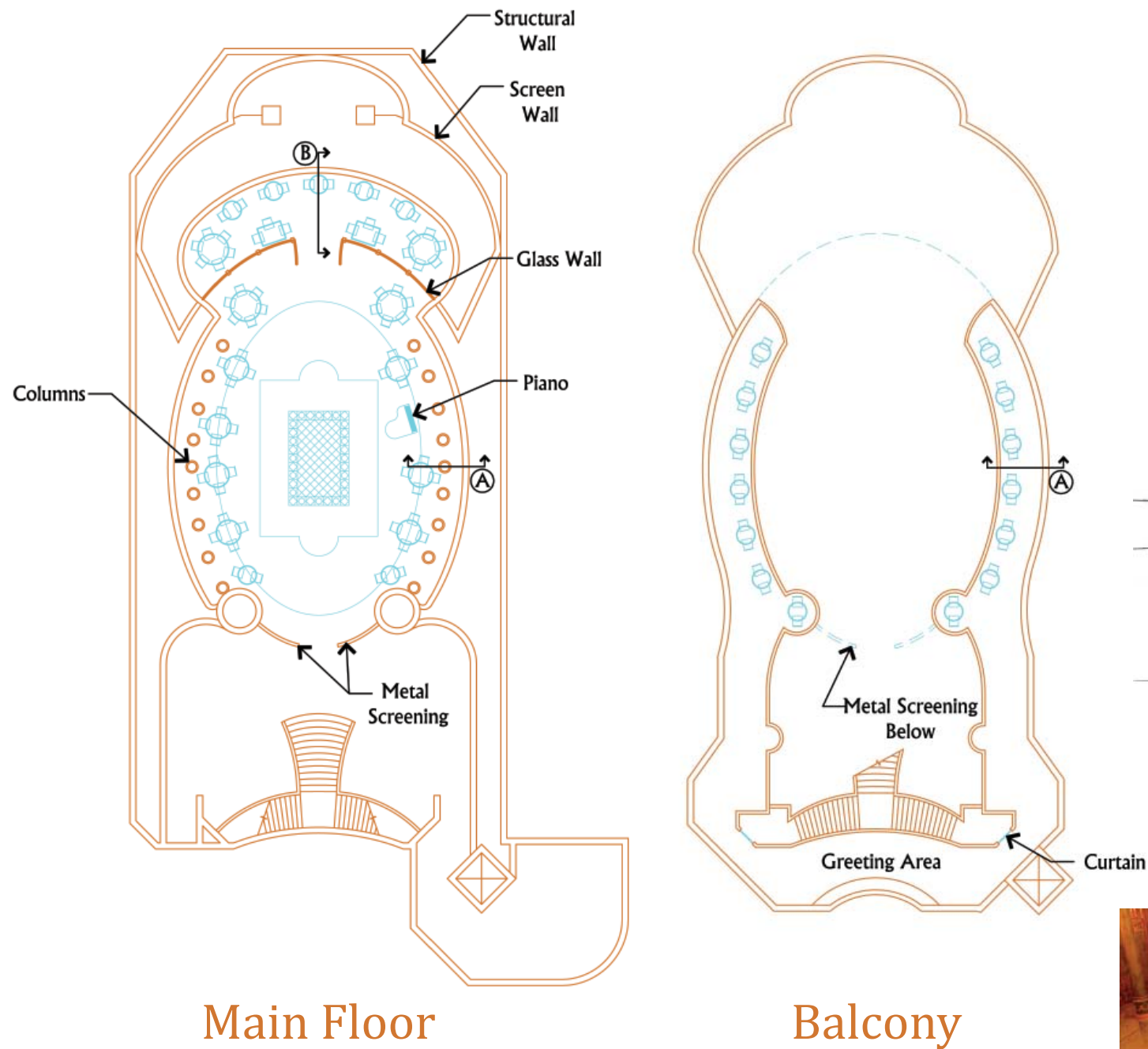

Description

This grand room recreates the ballroom scene and houses Lumière's, a fine dining restaurant. Guests have a private entrance and have the opportunity to step down the staircase just as Belle and the Beast did. The dining room is split into three sections: the main floor, ballroom balcony, and exterior balcony. Every hour Belle and the Beast appear and dance to "Tale as Old as Time." During the dance a fog comes over the floor and the Beast transforms into the Prince.

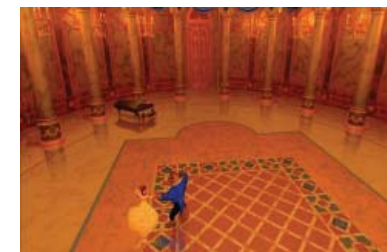
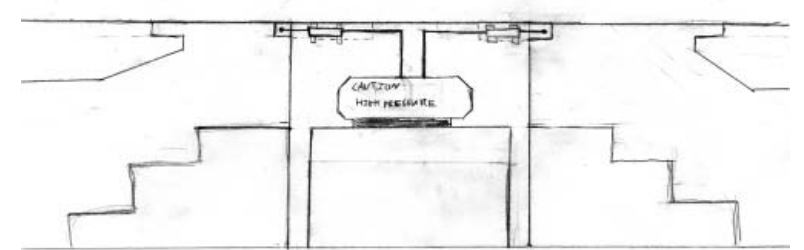

Ballroom Sections

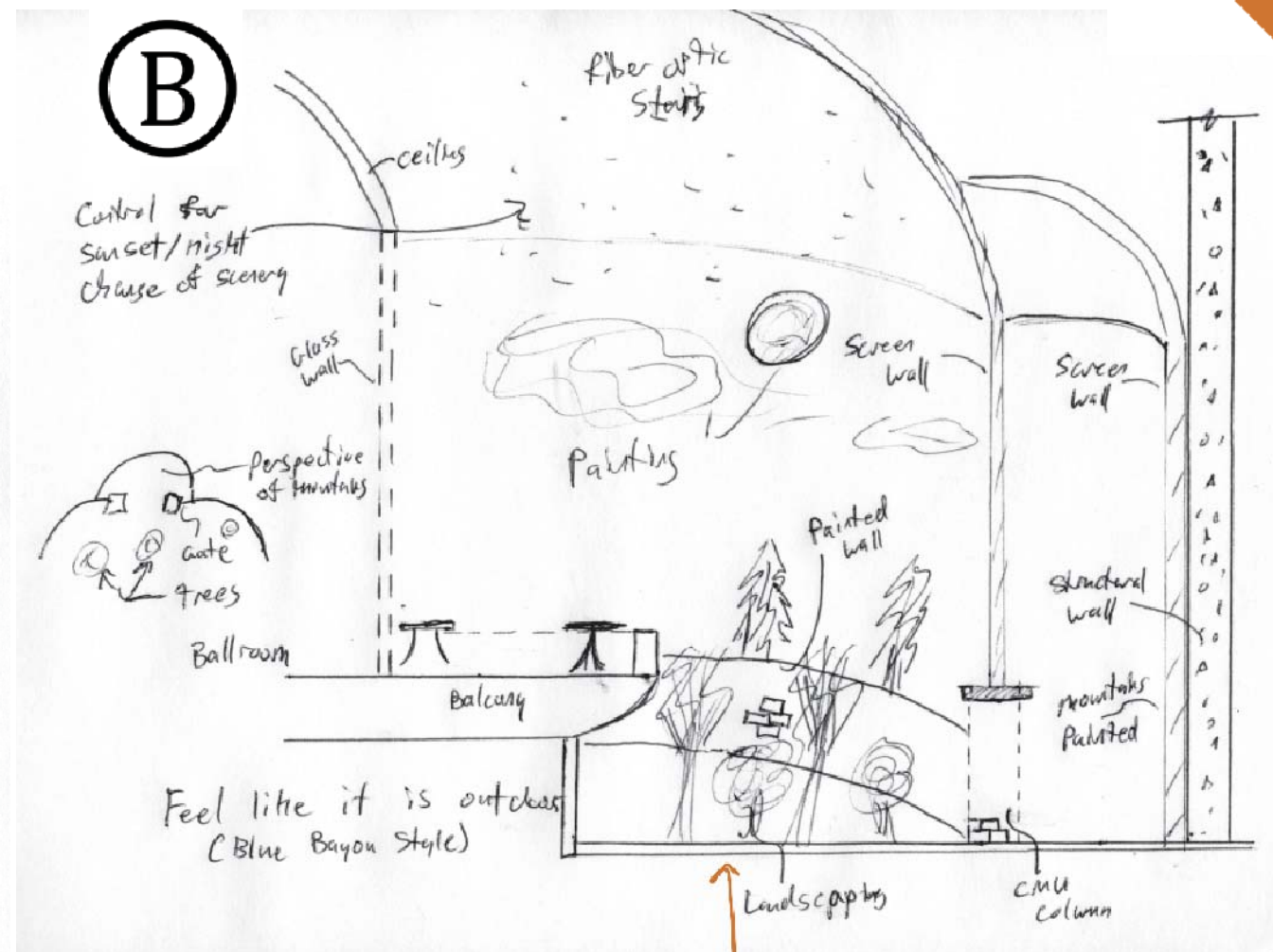
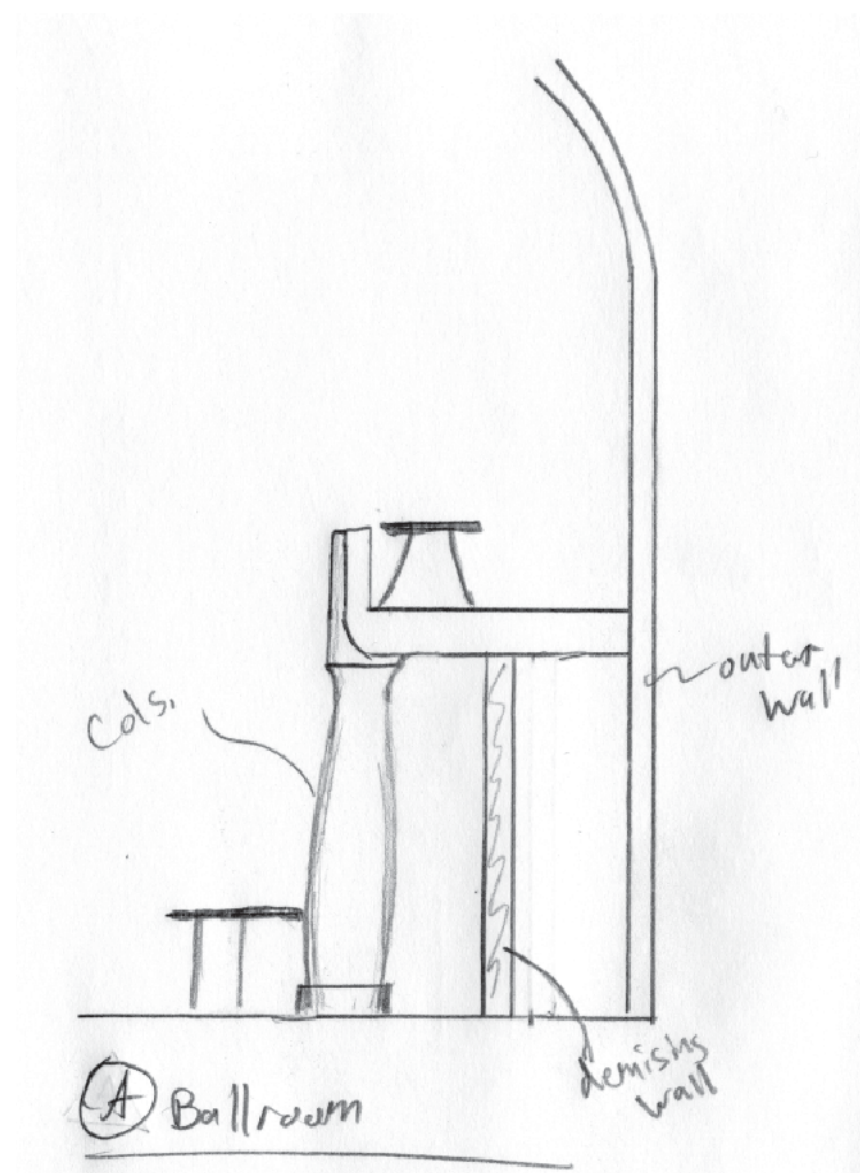

Walls painted & landscape below to feel like balcony is outside



Formal Gardens

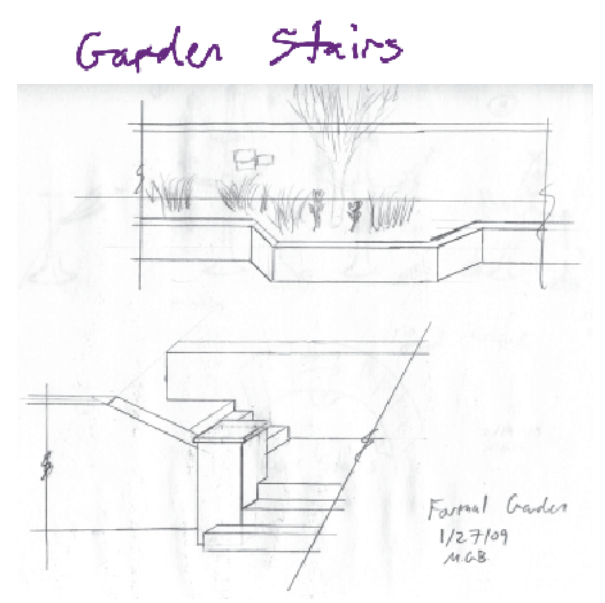
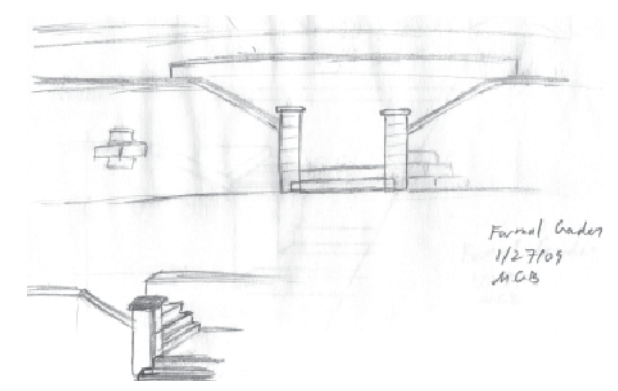
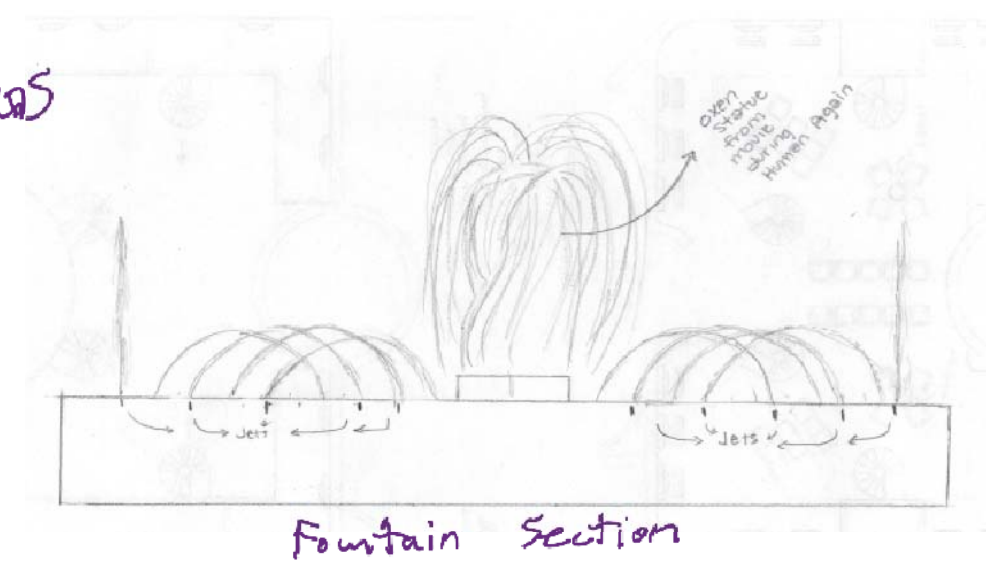
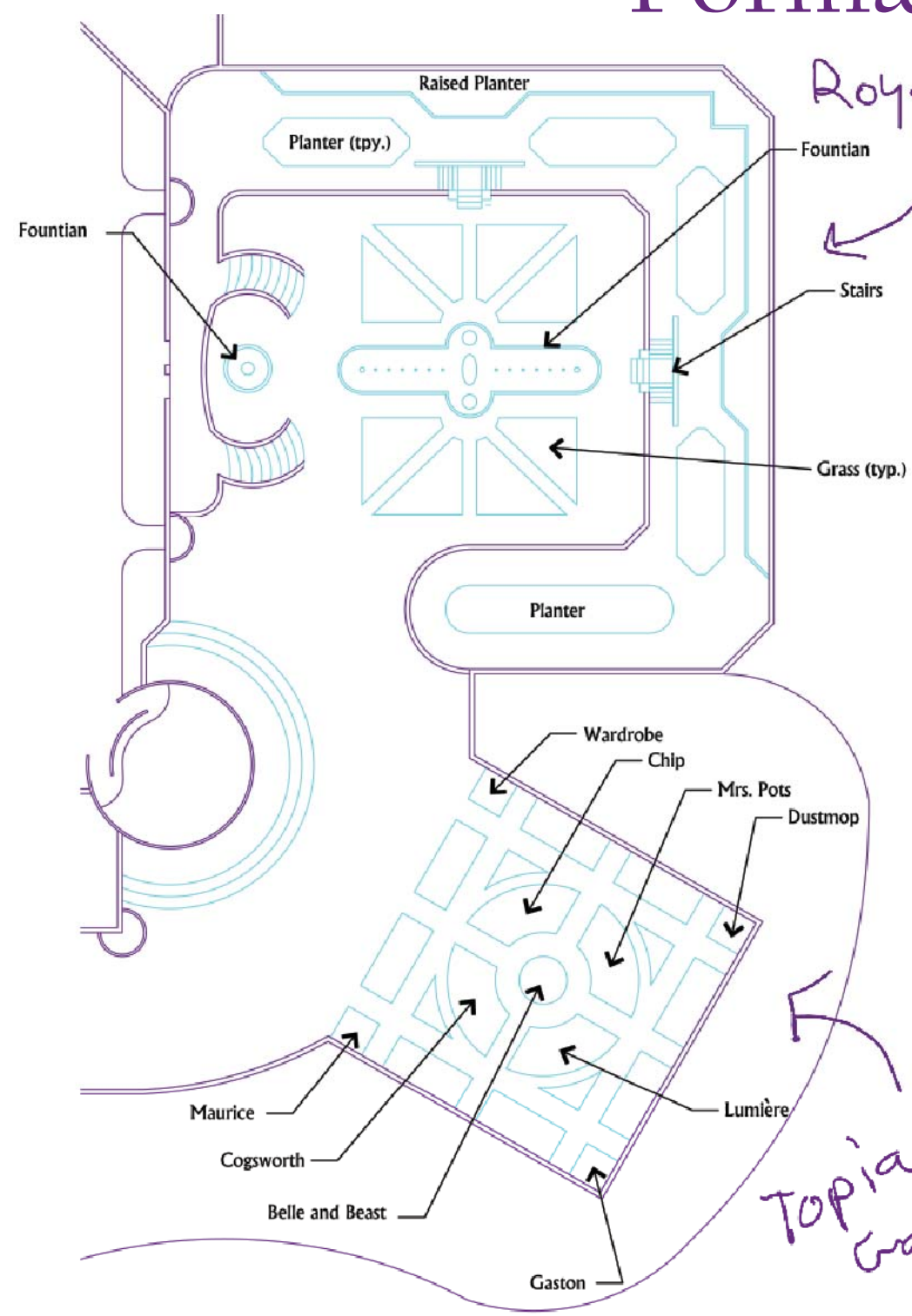

Royal Gardens Model

5.1



Le Château de la Belle et la Bête

Gardens

Philippe's Garden

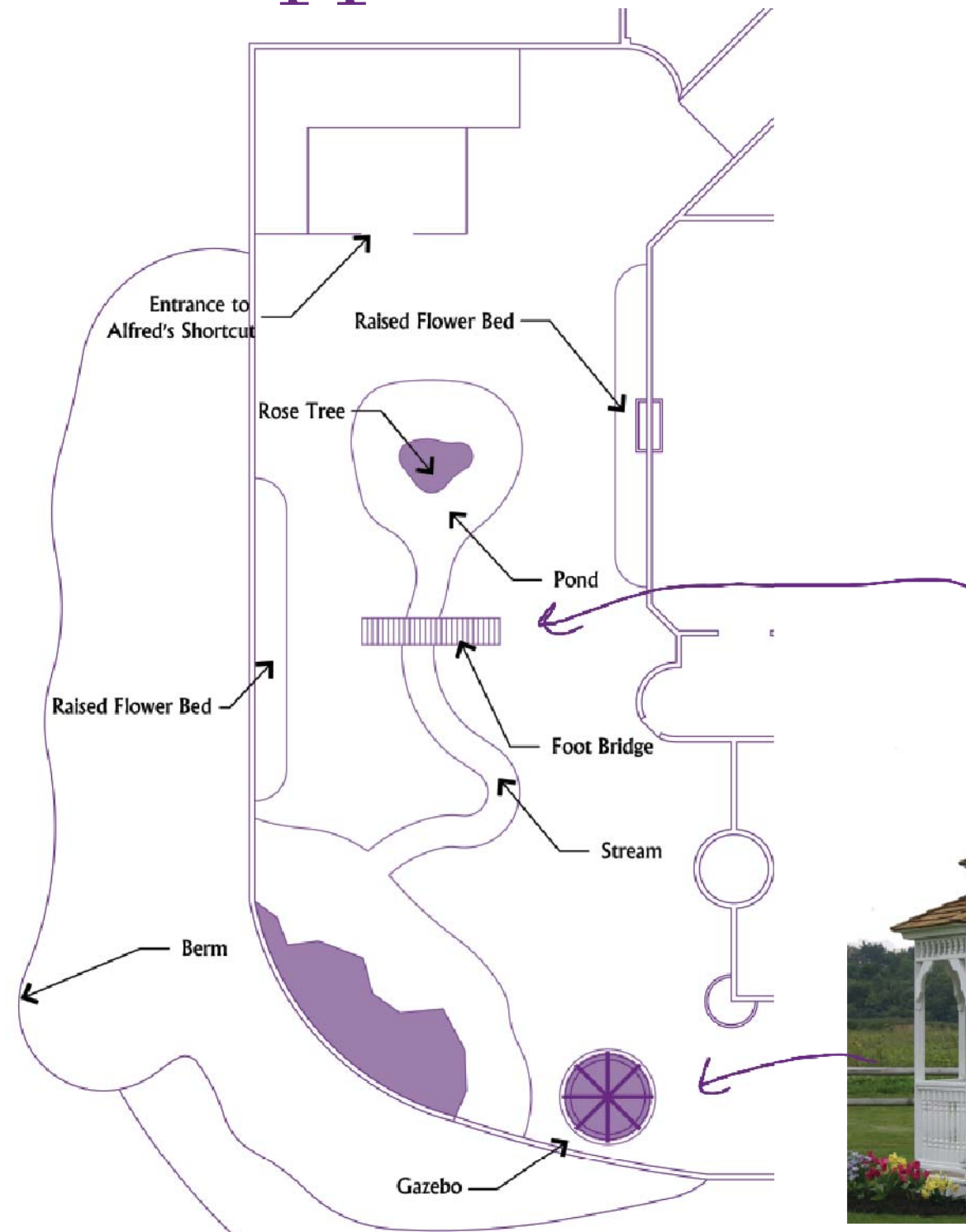

Description

On the west side of the castle is Philippe's Garden, a cottage styled garden where the stables are located. The stable is the queue for Alfred's Shortcut. Using trees and a berm the garden is able to isolate the castle from the rest of the park on the west side.

Alfred's Shortcut (Ride)

Description

Alfred, the Beast's driver, and Carté, his navigator, take you on an exhilarating adventure in Alfred's Shortcut. Alfred is taking you to the Village but Carté has not been outside in such a long time that the bridge she has led Alfred to is gone! You get to join them on a search for the way to town. Exiting to the village your adventure is complete.

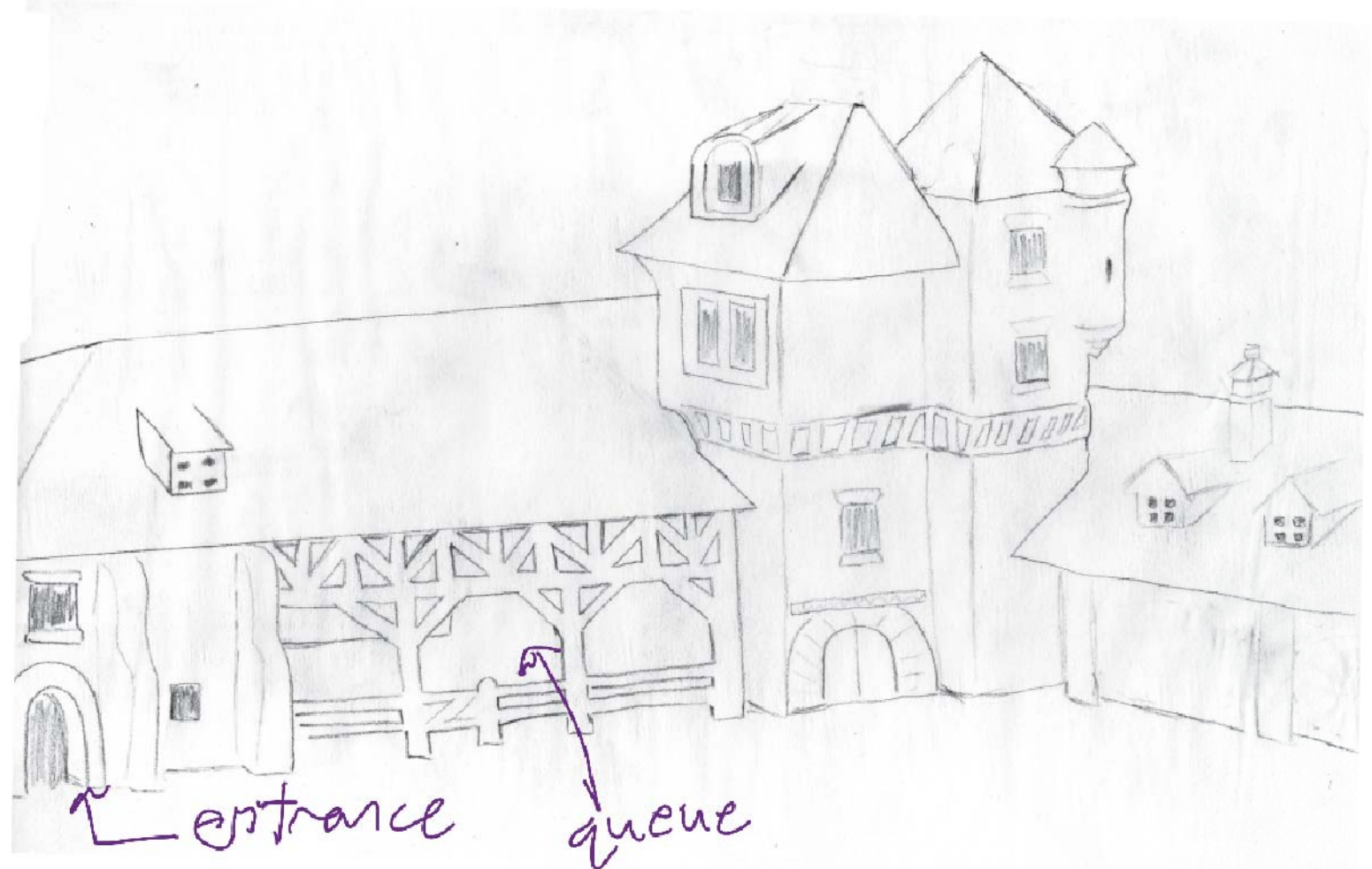
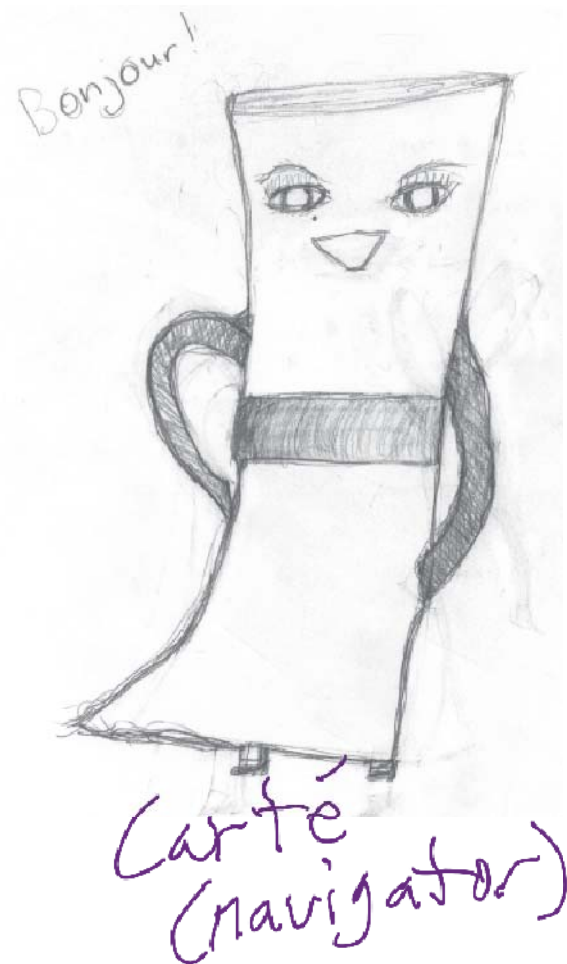

Alfred's Shortcut (Ride Vehicle)

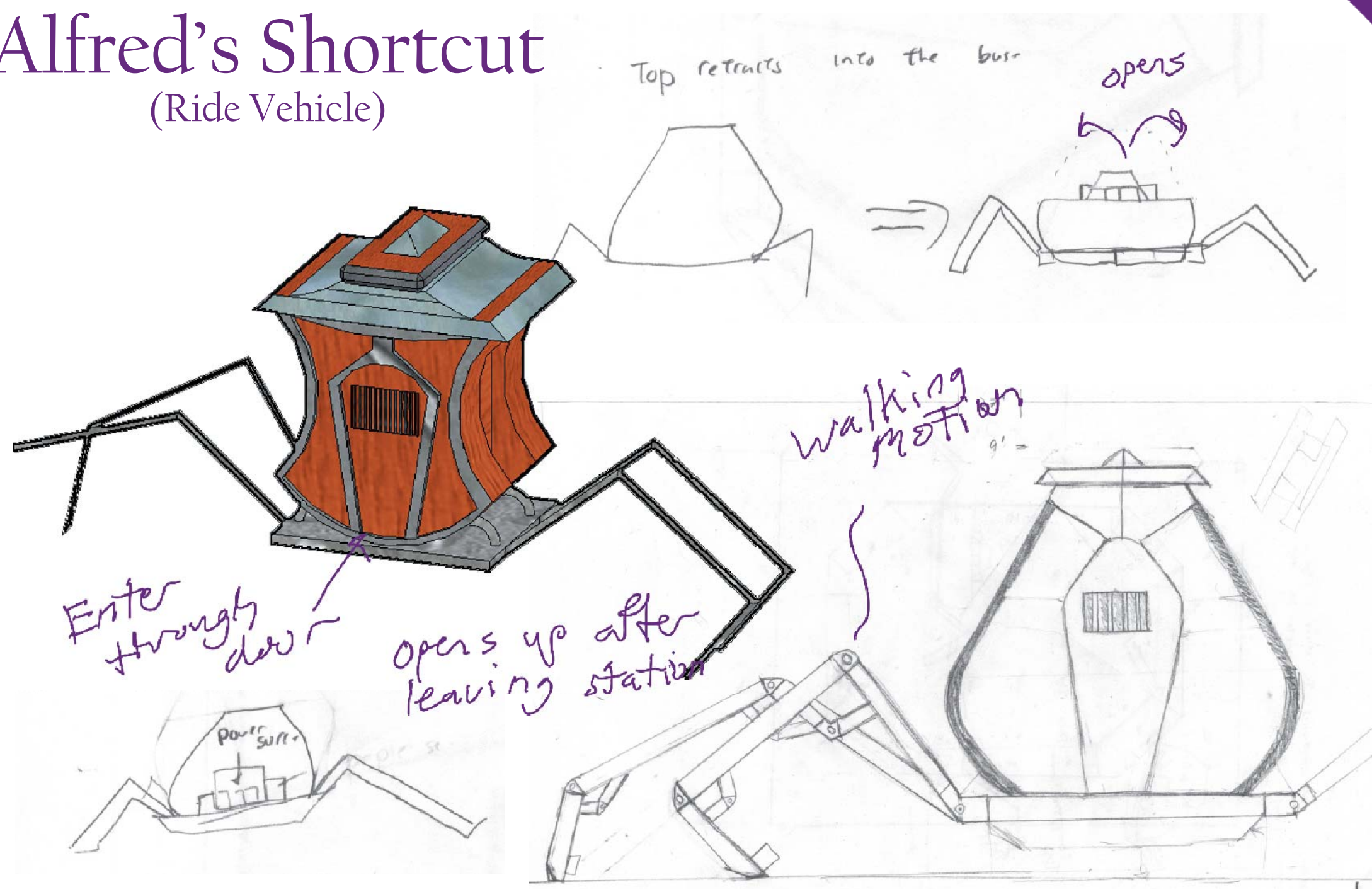

Castle Bridge & Front Gate

6.0

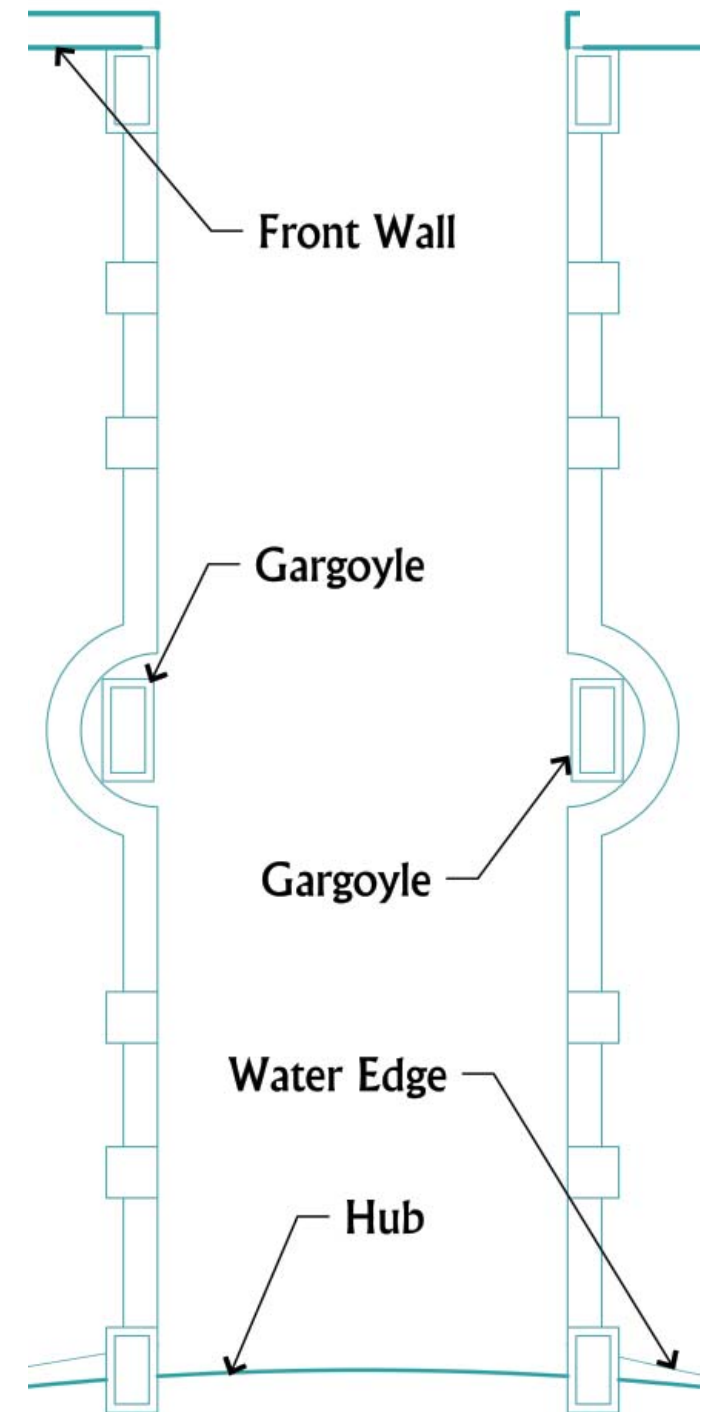
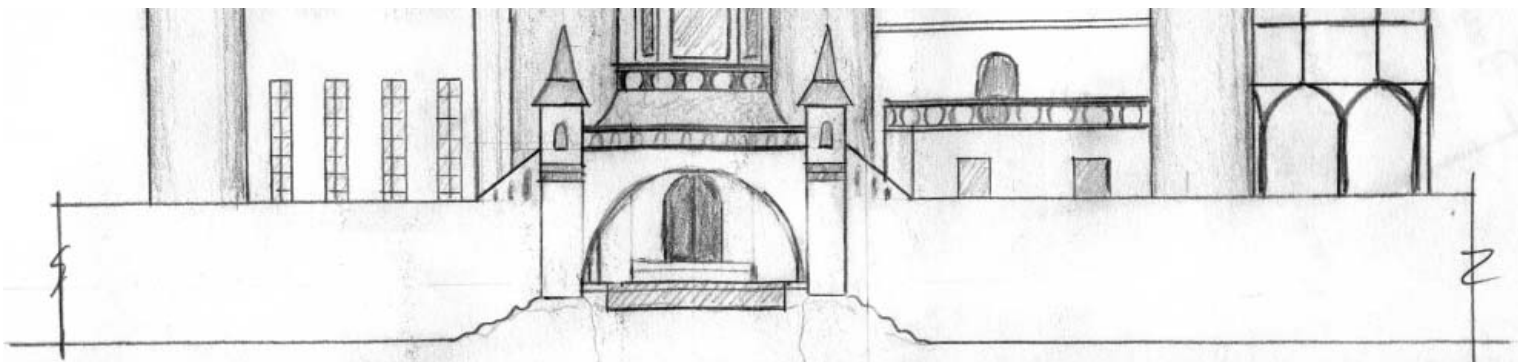
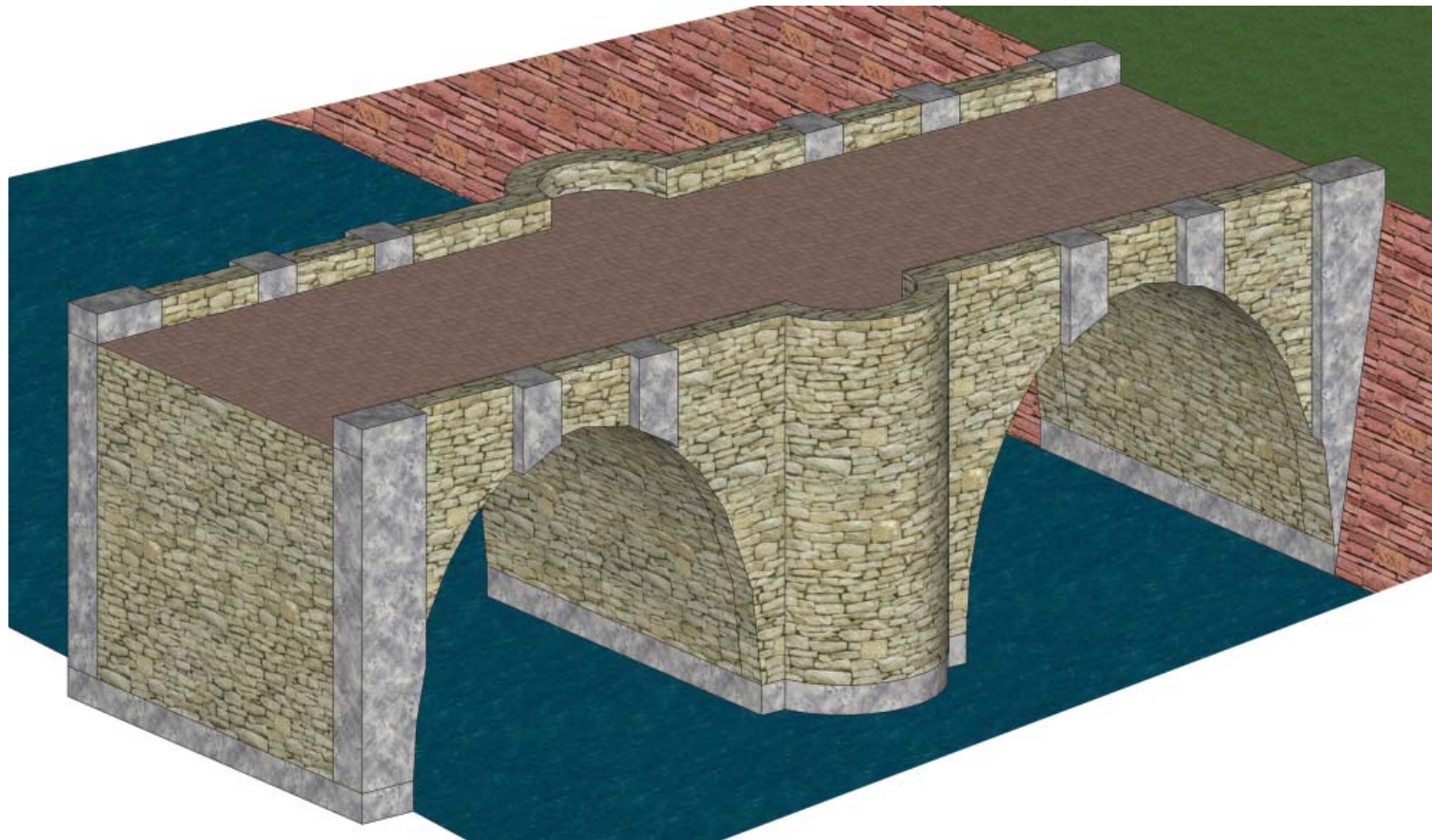

Le Château de la Belle et la Bête

Site

Belle's Courtyard 6.1

Details

- 1) Small Flower Beds
- 2) Small fountain
- 3) Benches
- 4) Balcony Above

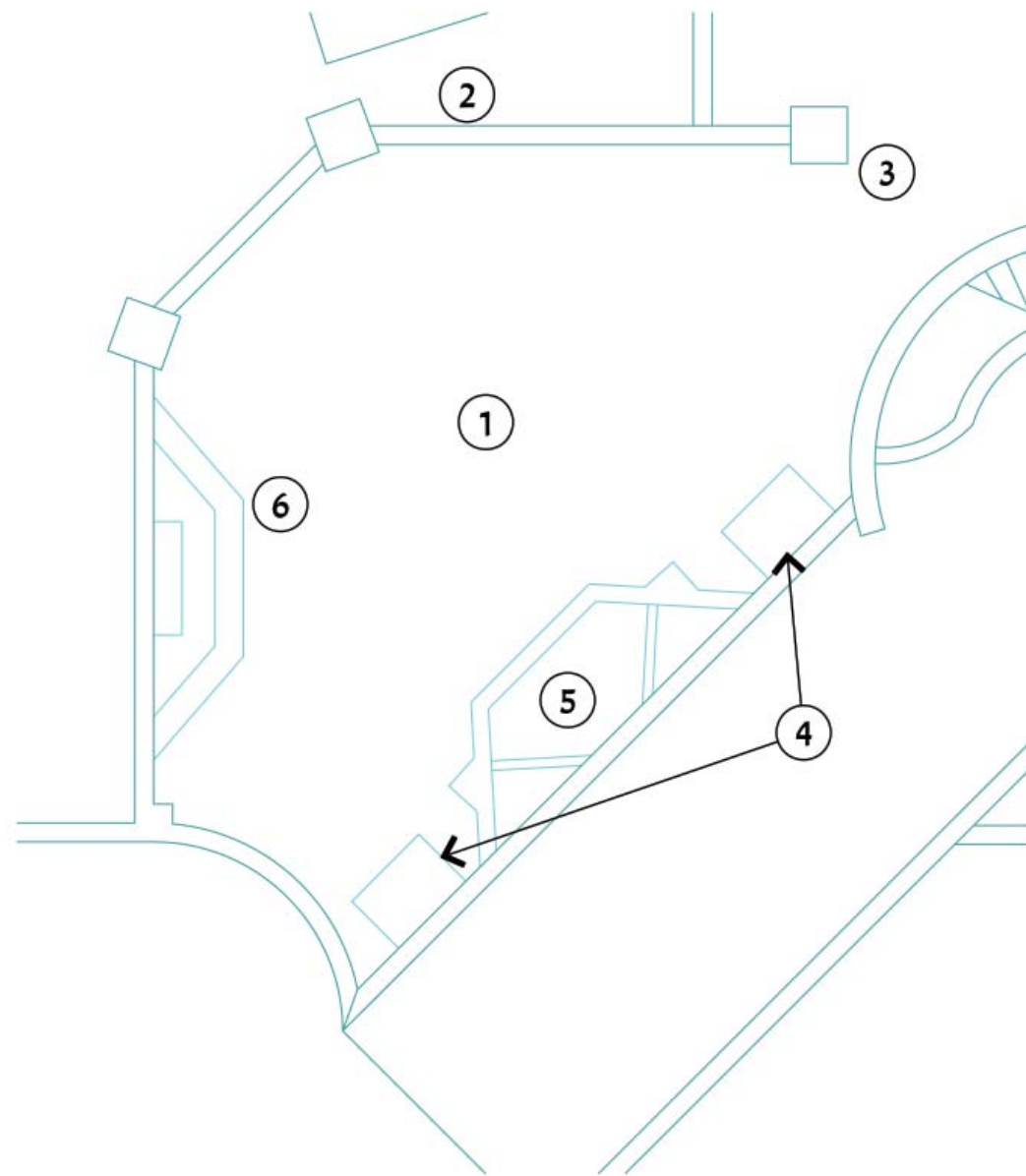
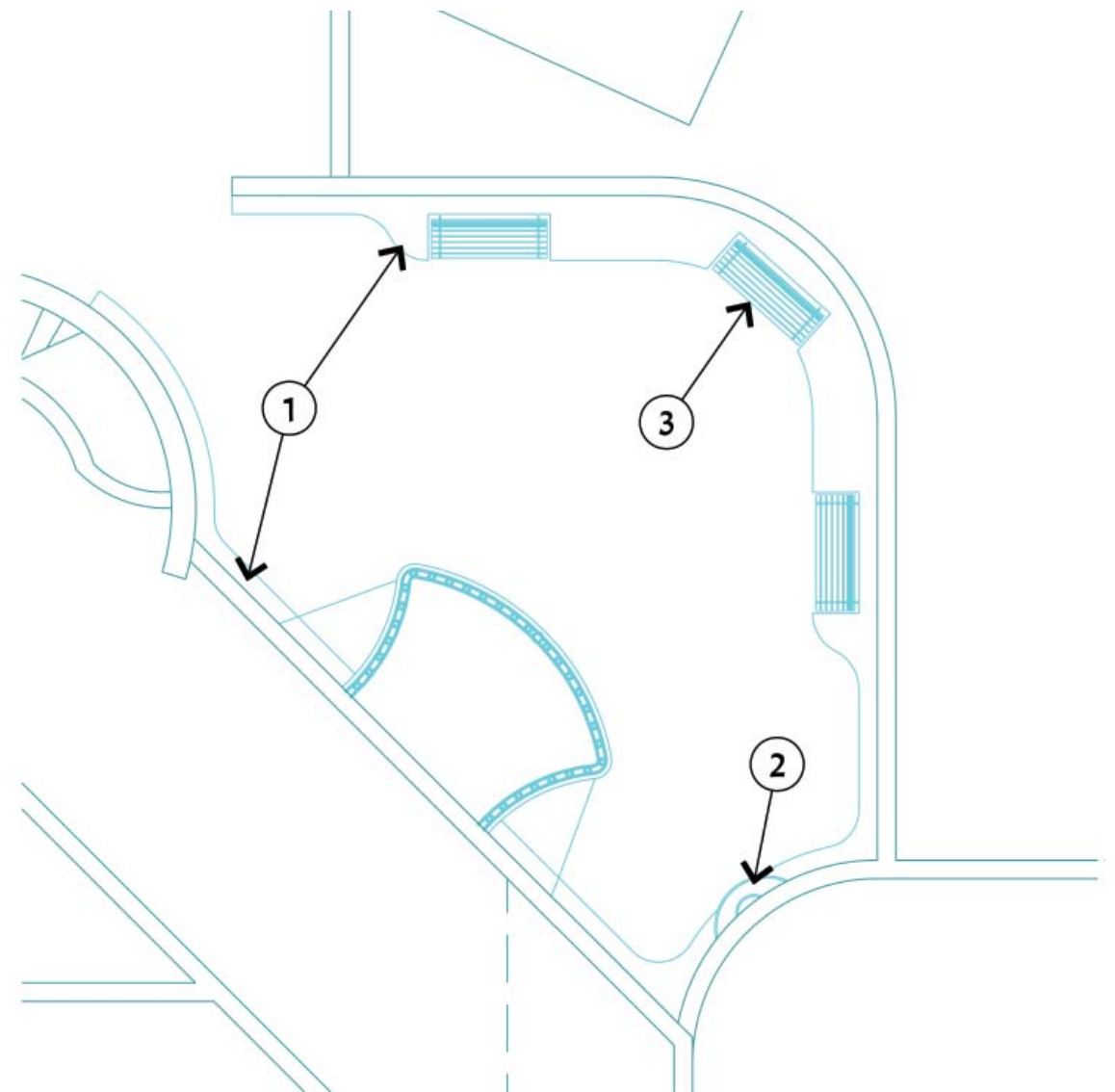

Details

- 1) Black high gloss tile
- 2) Rough Brick Exterior, and Smooth Interior
- 3) Masonry Columns
- 4) Twin gargoyles
- 5) Balcony Above
- 6) Fountain (black marble)

Beast's Courtyard

Village

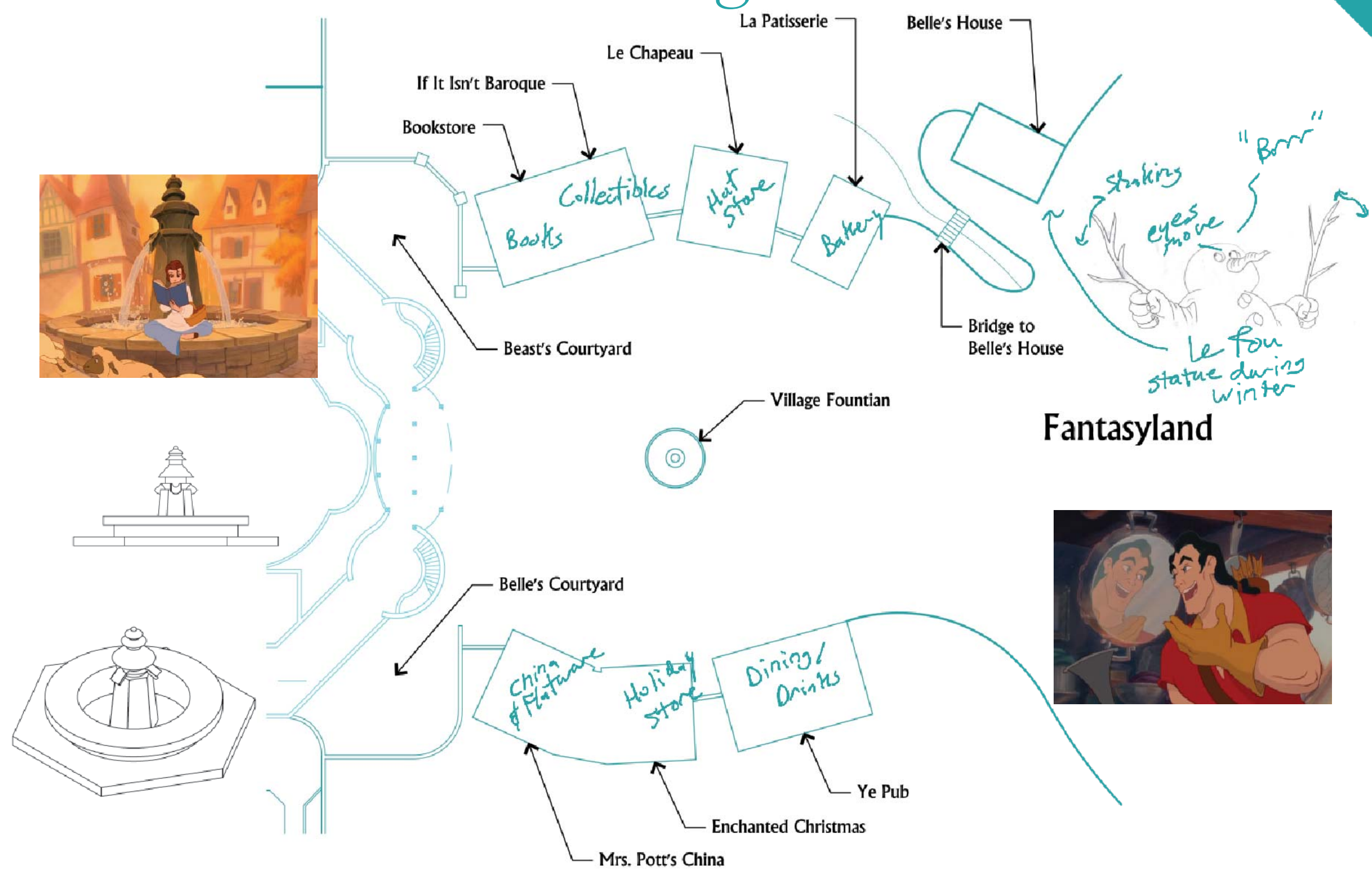

Belle's House

Description

Belle's home marks the beginning of Fantasyland. While guests will not be let into the house future expansion could include a walkthrough or interactive area called, "Maurice's Workshop". At given intervals Maurice's machine explodes causing smoke to come out of the building.

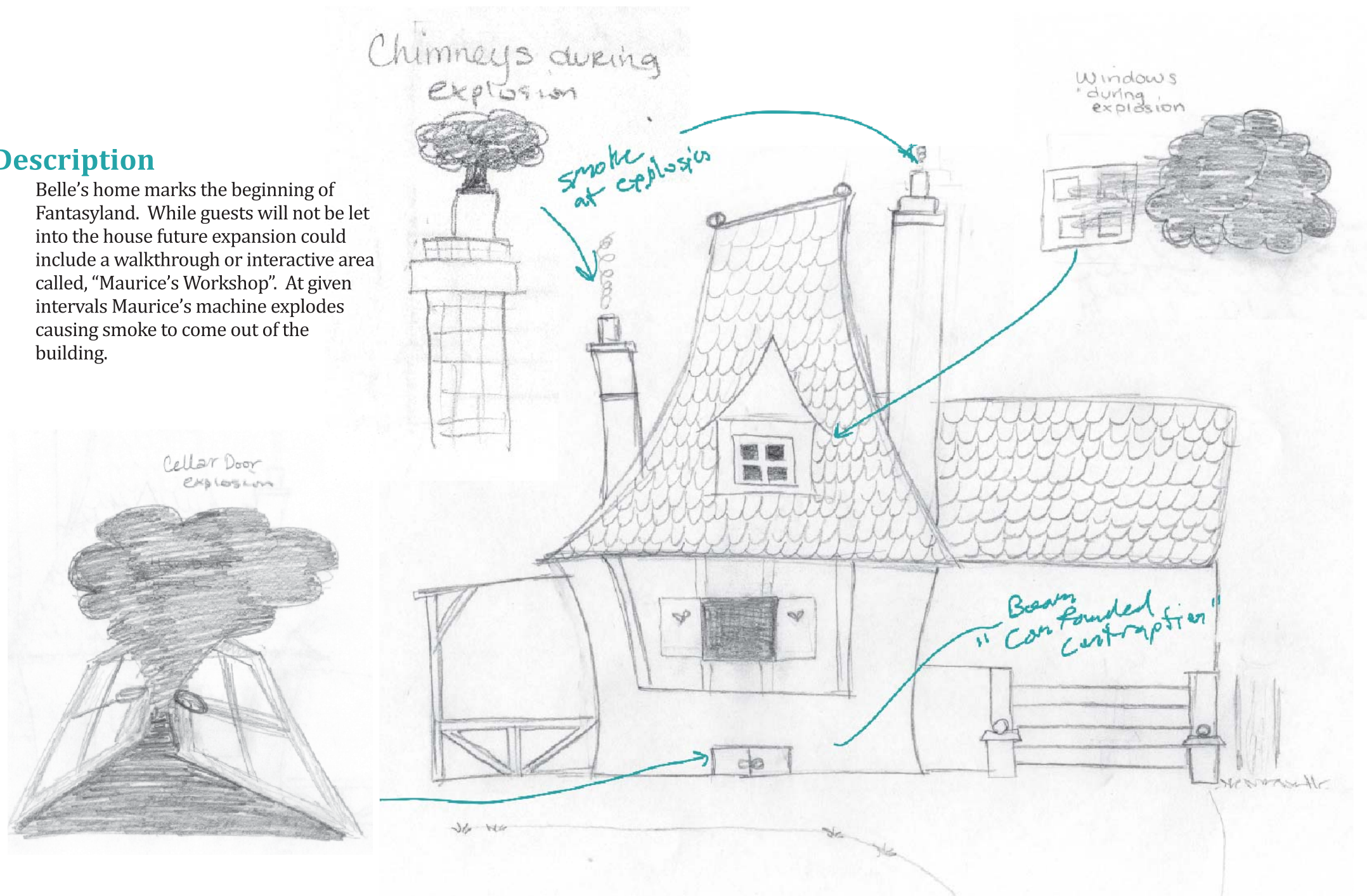

M. Gates Browne

M. Gates Browne

Brian Nicholls

Brian Nicholls

Daniel Berriz

Daniel Berriz

Sonia Runyan

Sonia Runyan

~ SPRING 2009 ~